



SIKA STANDARD DETAILS

SIKA HYDROTECH MONOLITHIC MEMBRANE 6125<sup>®</sup>

# CONTENTS

<b>PAGE</b>	<b>DETAIL REF.</b>	<b>DETAIL DESCRIPTION</b>
3	HT01C	Balcony upstand
4	HT02C	Upstand, no movement, monolithic substrate
5	HT03C	Upstand with movement, dissimilar materials/junctions
6	HT04C	Termination detail - Chase termination type 1
7	HT05C	Termination detail - double apron/over flashing
8	HT06C	Termination detail - Pressure bar (where a chase detail is not possible)
9	HT07C	Connection detail - to SikaProof Bentonite - Horizontal & Vertical lap
10	HT08C	Outlet and overflow connection details
11	HT09C	Outlet connection details - PMR Roof or Deck
12	HT10C	Outlet connection details - Cold Roof or Deck
13	HT11C	Outlet connection details - PMR/Green Roof
14	HT12C	Outlet connection details - Cold or Green Roof, no XPS insulation
15	HT13C	Outlet connection details - PMR/Ballast Roof
16	HT14C	Outlet connection details - Cold Roof with Asphalt Overlay
17	HT15C	Outlet connection details - Outlet/Scupper
18	HT16C	Penetration detail - option 1
19	HT17C	Penetration detail - plantwork
20	HT18C	Penetration detail - pipe
21	HT19C	Penetration detail - exposed, irregular shape
22	HT20C	Penetration detail - round shaped penetration
23	HT21C	PMR Roof or Cold Roof - paver and trafficable options
24	HT22C	PMR Roof or Cold Roof - asphalt options
25	HT23C	PMR Roof or Cold Roof - green roof options
26	HT24C	PMR Roof or Cold Roof - ballast roof options
27	HT25C	Expansion Joints up to 25 mm - floor and floor to wall

**Notes:**

Sika Hydrotech Monolithic Membrane 6125 must be overlaid with a Sika Approved Protection Layer or Hydroflex 30.

Use Sika Hydrotech Flex-Flash UN where minor movement or change in level direction or dissimilar materials occur.

Alternatively use Sika Hydrotech Flex-Flash F for concrete to concrete transitions.

Where the upstand is to be constructed of timber, then a minimum 13 mm high-density fibre cement board shall be placed over the upstand to receive the Sika Hydrotech membrane.

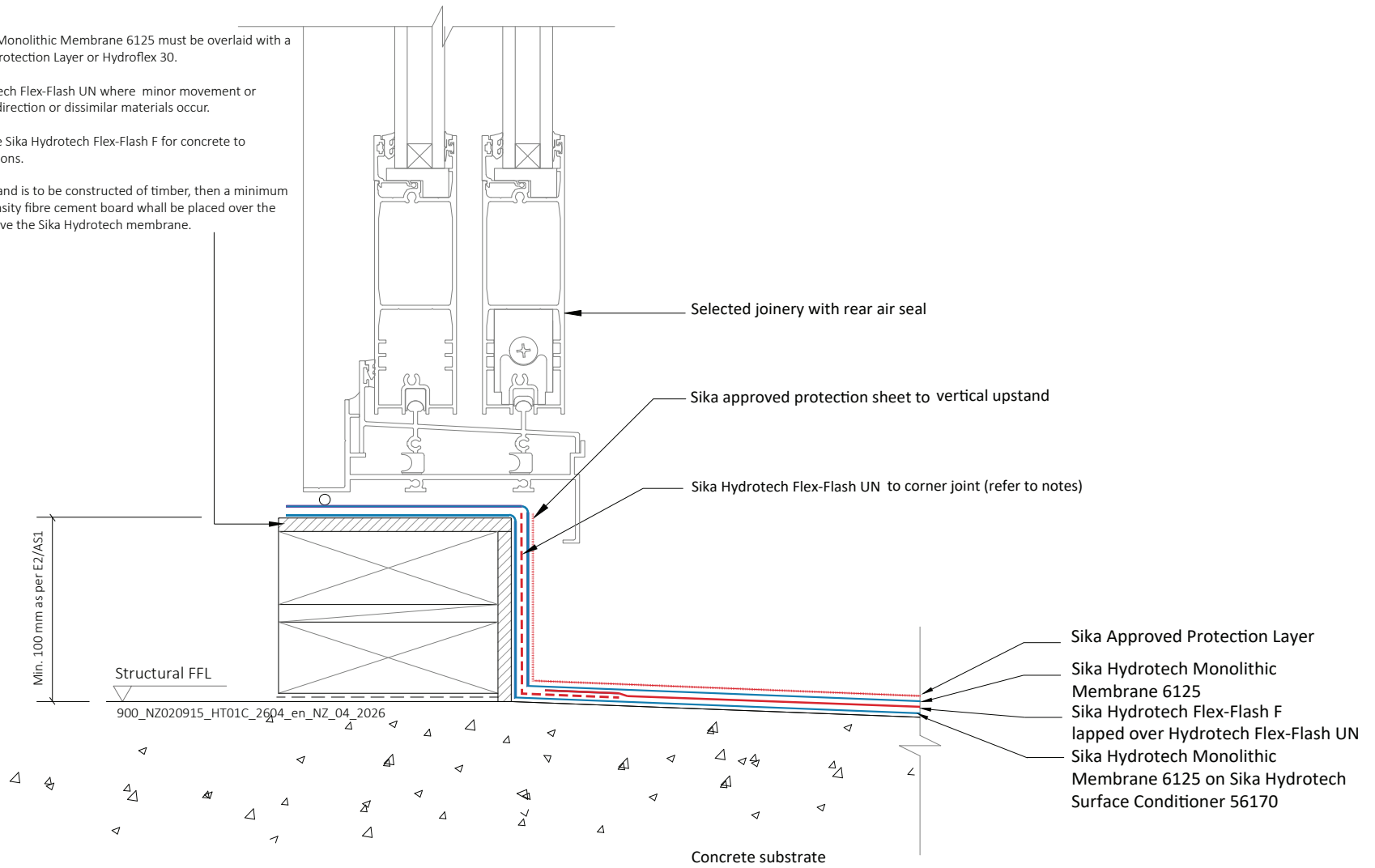

**SIKA HYDROTECH MONOLITHIC MEMBRANE 6125**

**Balcony Upstand**

General Detail. Not to scale.

900\_NZ020915\_HT01C\_2604\_en\_NZ\_04\_2026

April 2026

**Sika (NZ) Ltd**

85 Patiki Road

Auckland 1026

New Zealand.

Ph. 0800 745 269

www.sika.co.nz

DRAWING MUST ALWAYS BE REVIEWED BY A DESIGN SPECIALIST AND IF NECESSARY MODIFIED TO ENSURE SUITABILITY FOR THE SPECIFIC APPLICATION

The information contained herein and any other advice are given in good faith based on Sika's current knowledge and experience of the products when properly stored, handled and applied under normal conditions in accordance with Sika's recommendations. The information only applies to the application(s) and product(s) expressly referred to herein and is based on laboratory tests which do not replace practical tests. In case of changes in the parameters of the application, such as changes in substrates etc., or in case of a different application, consult Sika's Technical Service prior to using Sika products. The information contained herein does not relieve the user of the products from testing them for the intended application and purpose. All orders are accepted subject to our current terms of sale and delivery. Users must always refer to the most recent issue of the local Product Data Sheet for the product concerned, copies of which will be supplied on request.

**BUILDING TRUST**



Notes:  
 Sika Hydrotech Monolithic Membrane 6125 must be overlaid with a Sika Approved Protection Layer or Hydroflex 30.

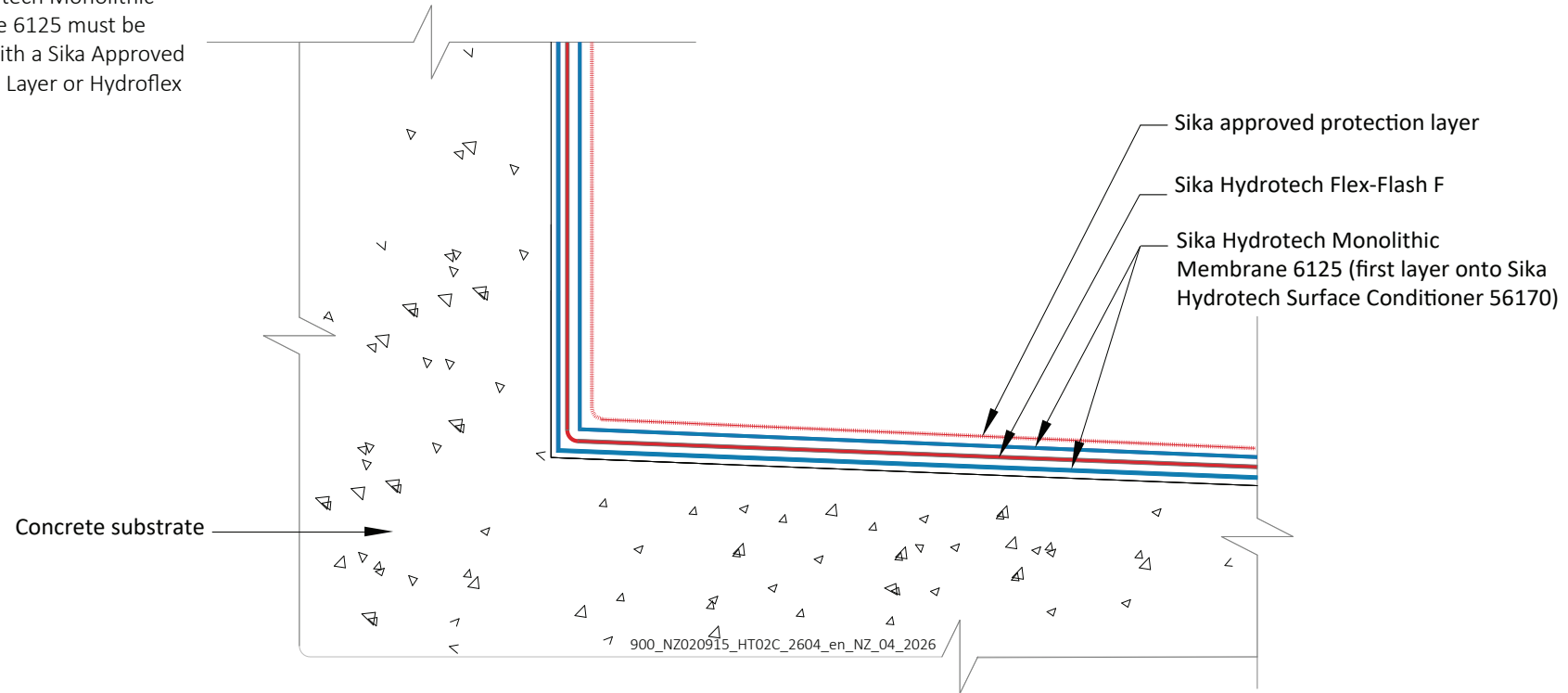

**SIKA HYDROTECH MONOLITHIC MEMBRANE 6125**

Upstand, no movement, monolithic substrate

General Detail. Not to scale.

900\_NZ020915\_HT02C\_2604\_en\_NZ\_04\_2026

April 2026

**Sika (NZ) Ltd**

85 Patiki Road

Auckland 1026

New Zealand.

Ph. 0800 745 269

www.sika.co.nz

DRAWING MUST ALWAYS BE REVIEWED BY A DESIGN SPECIALIST AND IF NECESSARY MODIFIED TO ENSURE SUITABILITY FOR THE SPECIFIC APPLICATION

The information contained herein and any other advice are given in good faith based on Sika's current knowledge and experience of the products when properly stored, handled and applied under normal conditions in accordance with Sika's recommendations. The information only applies to the application(s) and product(s) expressly referred to herein and is based on laboratory tests which do not replace practical tests. In case of changes in the parameters of the application, such as changes in substrates etc., or in case of a different application, consult Sika's Technical Service prior to using Sika products. The information contained herein does not relieve the user of the products from testing them for the intended application and purpose. All orders are accepted subject to our current terms of sale and delivery. Users must always refer to the most recent issue of the local Product Data Sheet for the product concerned, copies of which will be supplied on request.

**BUILDING TRUST**



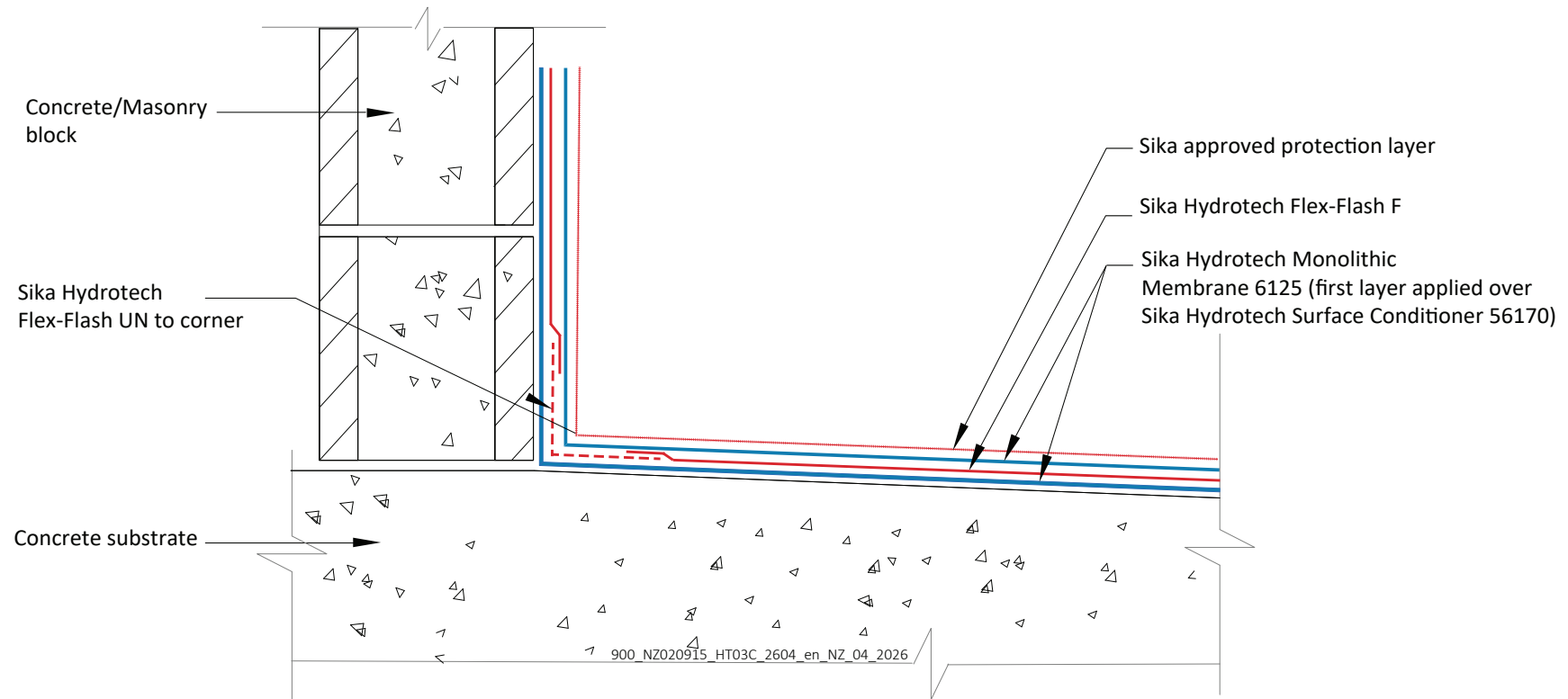

**Notes:**

Sika Hydrotech Monolithic Membrane 6125 must be overlaid with a Sika Approved Protection Layer or Hydroflex 30.

For concrete to concrete transitions, use Sika Hydrotech Flex-Flash F. Otherwise, where minor movement or change in level direction, or dissimilar materials occur, use Sika Hydrotech Flex-Flash UN.

**SIKA HYDROTECH MONOLITHIC MEMBRANE 6125**  
Upstand with movement, dissimilar materials/junctions

General Detail. Not to scale.

900\_NZ020915\_HT03C\_2604\_en\_NZ\_04\_2026

April 2026

**Sika (NZ) Ltd**

85 Patiki Road

Auckland 1026

New Zealand.

Ph. 0800 745 269

www.sika.co.nz

DRAWING MUST ALWAYS BE REVIEWED BY A DESIGN SPECIALIST AND IF NECESSARY MODIFIED TO ENSURE SUITABILITY FOR THE SPECIFIC APPLICATION

The information contained herein and any other advice are given in good faith based on Sika's current knowledge and experience of the products when properly stored, handled and applied under normal conditions in accordance with Sika's recommendations. The information only applies to the application(s) and product(s) expressly referred to herein and is based on laboratory tests which do not replace practical tests. In case of changes in the parameters of the application, such as changes in substrates etc., or in case of a different application, consult Sika's Technical Service prior to using Sika products. The information contained herein does not relieve the user of the products from testing them for the intended application and purpose. All orders are accepted subject to our current terms of sale and delivery. Users must always refer to the most recent issue of the local Product Data Sheet for the product concerned, copies of which will be supplied on request.

**BUILDING TRUST**



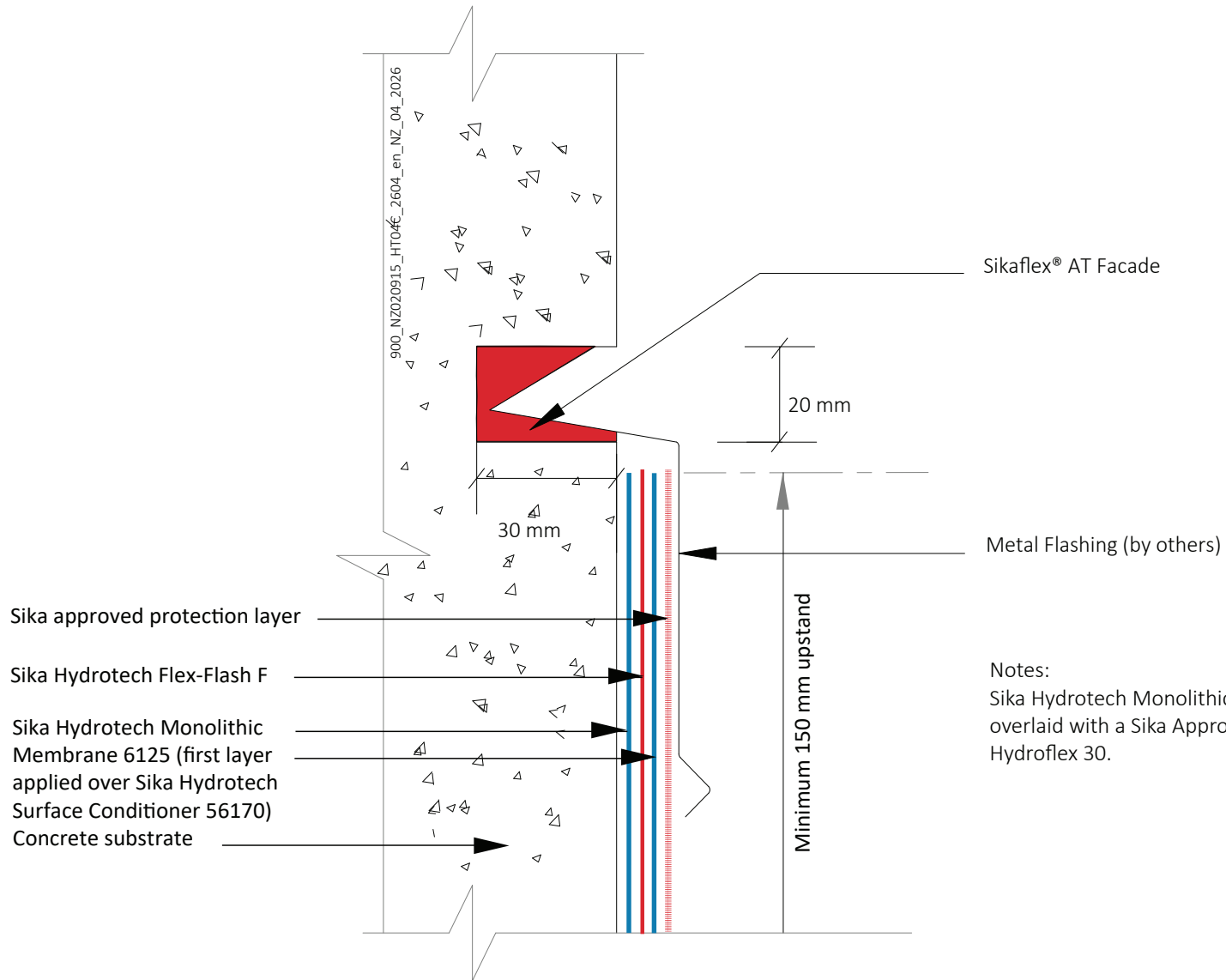

Notes:  
 Sika Hydrotech Monolithic Membrane 6125 must be overlaid with a Sika Approved Protection Layer or Hydroflex 30.

**SIKA HYDROTECH MONOLITHIC MEMBRANE 6125**

Termination Detail- Chase Termination Type 1

General Detail. Not to scale.

900\_NZ020915\_HT04C\_2604\_en\_NZ\_04\_2026

April 2026

**Sika (NZ) Ltd**

85 Patiki Road

Auckland 1026

New Zealand.

Ph. 0800 745 269

www.sika.co.nz

DRAWING MUST ALWAYS BE REVIEWED BY A DESIGN SPECIALIST AND IF NECESSARY MODIFIED TO ENSURE SUITABILITY FOR THE SPECIFIC APPLICATION

The information contained herein and any other advice are given in good faith based on Sika's current knowledge and experience of the products when properly stored, handled and applied under normal conditions in accordance with Sika's recommendations. The information only applies to the application(s) and product(s) expressly referred to herein and is based on laboratory tests which do not replace practical tests. In case of changes in the parameters of the application, such as changes in substrates etc., or in case of a different application, consult Sika's Technical Service prior to using Sika products. The information contained herein does not relieve the user of the products from testing them for the intended application and purpose. All orders are accepted subject to our current terms of sale and delivery. Users must always refer to the most recent issue of the local Product Data Sheet for the product concerned, copies of which will be supplied on request.

**BUILDING TRUST**



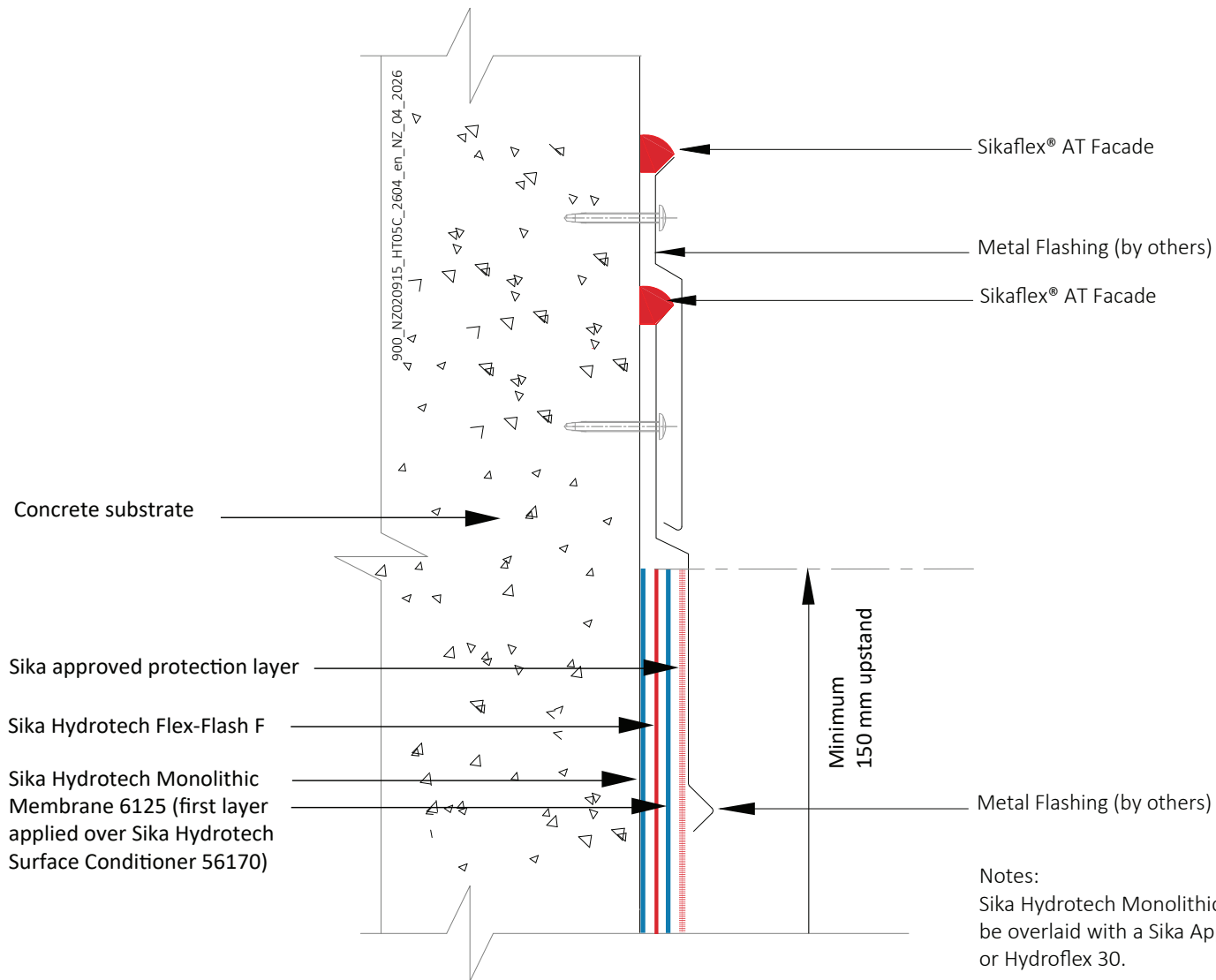

Notes:  
Sika Hydrotech Monolithic Membrane 6125 must be overlaid with a Sika Approved Protection Layer or Hydroflex 30.

## SIKA HYDROTECH MONOLITHIC MEMBRANE 6125

Termination Detail- Double Apron/Over Flashing

General Detail. Not to scale.

900\_NZ020915\_HT05C\_2604\_en\_NZ\_04\_2026

April 2026

Sika (NZ) Ltd

85 Patiki Road

Auckland 1026

New Zealand.

Ph. 0800 745 269

www.sika.co.nz

DRAWING MUST ALWAYS BE REVIEWED BY A DESIGN SPECIALIST AND IF NECESSARY MODIFIED TO ENSURE SUITABILITY FOR THE SPECIFIC APPLICATION  
The information contained herein and any other advice are given in good faith based on Sika's current knowledge and experience of the products when properly stored, handled and applied under normal conditions in accordance with Sika's recommendations. The information only applies to the application(s) and product(s) expressly referred to herein and is based on laboratory tests which do not replace practical tests. In case of changes in the parameters of the application, such as changes in substrates etc., or in case of a different application, consult Sika's Technical Service prior to using Sika products. The information contained herein does not relieve the user of the products from testing them for the intended application and purpose. All orders are accepted subject to our current terms of sale and delivery. Users must always refer to the most recent issue of the local Product Data Sheet for the product concerned, copies of which will be supplied on request.

**BUILDING TRUST**



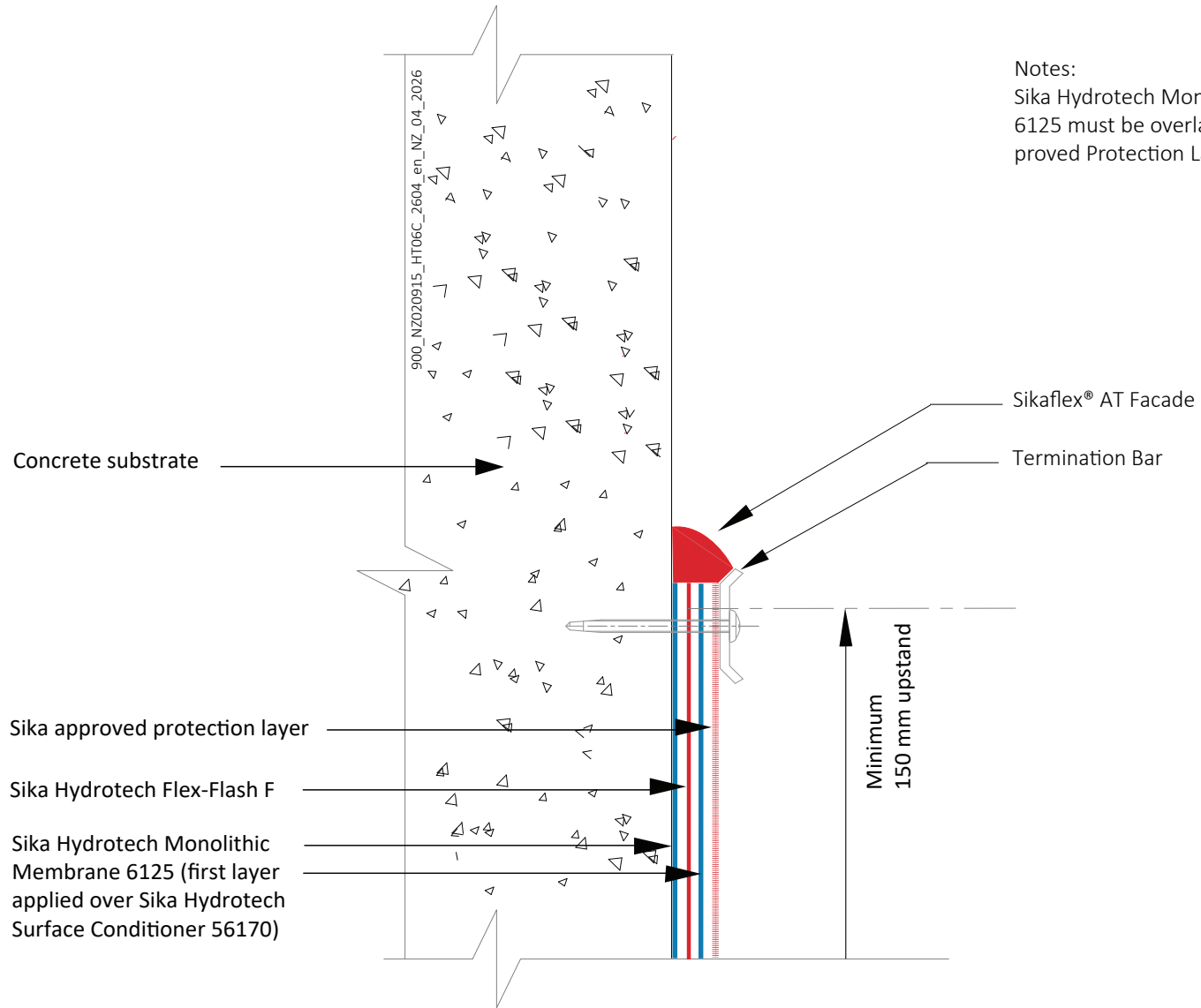

Notes:  
 Sika Hydrotech Monolithic Membrane 6125 must be overlaid with a Sika Approved Protection Layer or Hydroflex 30.

**SIKA HYDROTECH MONOLITHIC MEMBRANE 6125**

Termination Detail- Pressure Bar (only where a chase detail is not possible)

General Detail. Not to scale.

900\_NZ020915\_HT06C\_2604\_en\_NZ\_04\_2026

April 2026

Sika (NZ) Ltd

85 Patiki Road

Auckland 1026

New Zealand.

Ph. 0800 745 269

www.sika.co.nz

DRAWING MUST ALWAYS BE REVIEWED BY A DESIGN SPECIALIST AND IF NECESSARY MODIFIED TO ENSURE SUITABILITY FOR THE SPECIFIC APPLICATION  
 The information contained herein and any other advice are given in good faith based on Sika's current knowledge and experience of the products when properly stored, handled and applied under normal conditions in accordance with Sika's recommendations. The information only applies to the application(s) and product(s) expressly referred to herein and is based on laboratory tests which do not replace practical tests. In case of changes in the parameters of the application, such as changes in substrates etc., or in case of a different application, consult Sika's Technical Service prior to using Sika products. The information contained herein does not relieve the user of the products from testing them for the intended application and purpose. All orders are accepted subject to our current terms of sale and delivery. Users must always refer to the most recent issue of the local Product Data Sheet for the product concerned, copies of which will be supplied on request.

**BUILDING TRUST**



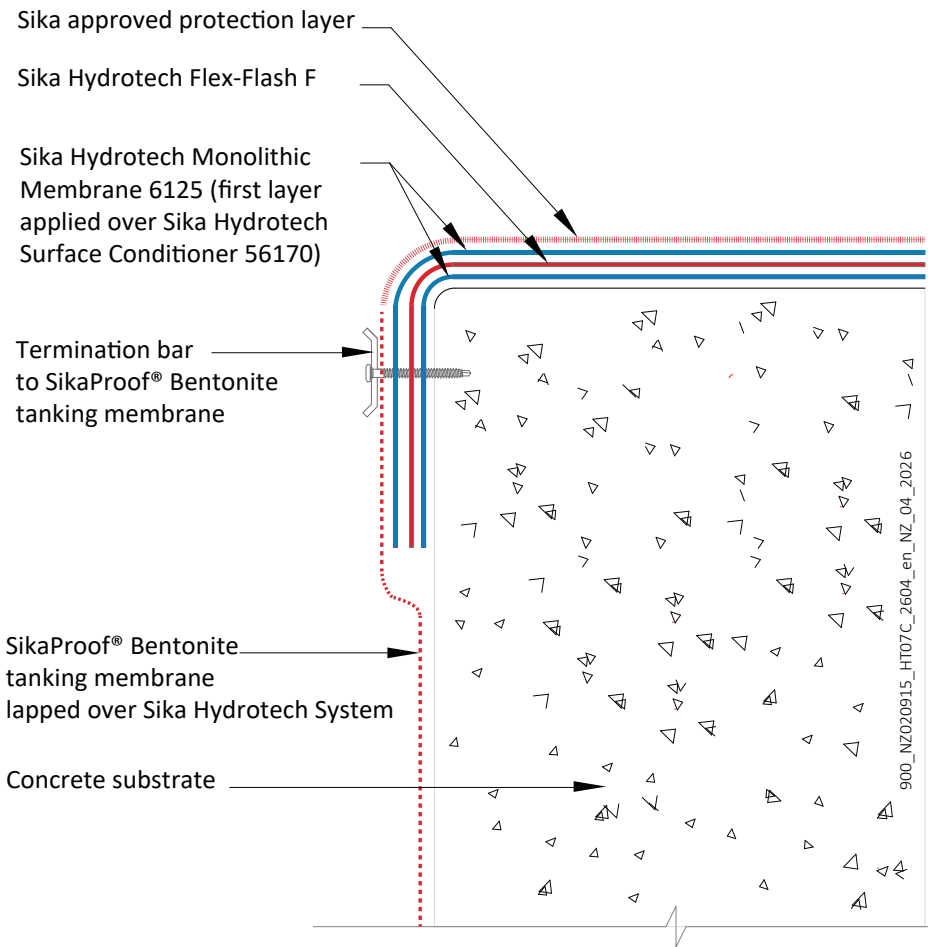

Vertical Lap Under SikaProof Bentonite Tanking

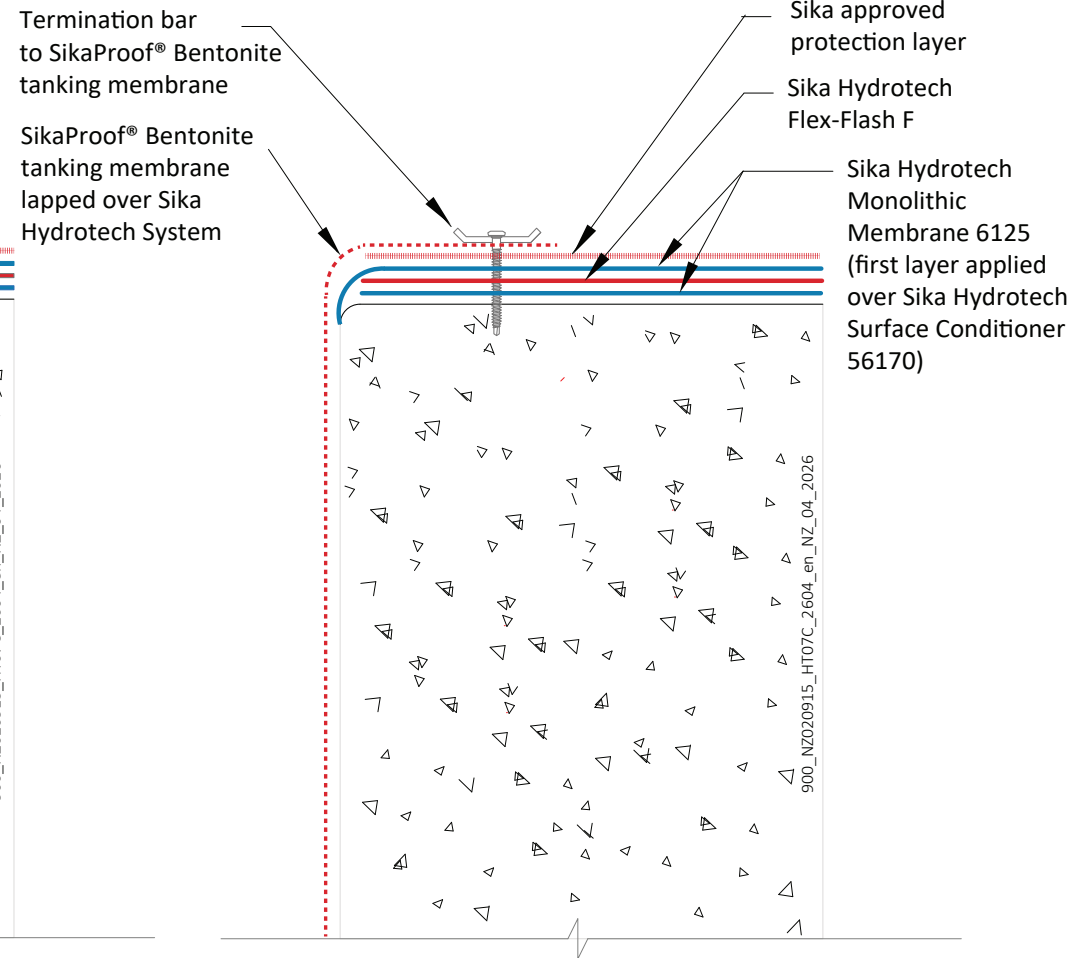

Horizontal Lap Under SikaProof Bentonite Tanking

**Notes:**

Sika Hydrotech Monolithic Membrane 6125 must be overlaid with a Sika Approved Protection Layer or Hydroflex 30.

**SIKA HYDROTECH MONOLITHIC MEMBRANE 6125**

SikaProof Bentonite Connection Details

General Detail. Not to scale.

900\_NZ020915\_HT07C\_2604\_en\_NZ\_04\_2026

April 2026

**Sika (NZ) Ltd**

85 Patiki Road

Auckland 1026

New Zealand.

Ph. 0800 745 269

www.sika.co.nz

DRAWING MUST ALWAYS BE REVIEWED BY A DESIGN SPECIALIST AND IF NECESSARY MODIFIED TO ENSURE SUITABILITY FOR THE SPECIFIC APPLICATION

The information contained herein and any other advice are given in good faith based on Sika's current knowledge and experience of the products when properly stored, handled and applied under normal conditions in accordance with Sika's recommendations. The information only applies to the application(s) and product(s) expressly referred to herein and is based on laboratory tests which do not replace practical tests. In case of changes in the parameters of the application, such as changes in substrates etc., or in case of a different application, consult Sika's Technical Service prior to using Sika products. The information contained herein does not relieve the user of the products from testing them for the intended application and purpose. All orders are accepted subject to our current terms of sale and delivery. Users must always refer to the most recent issue of the local Product Data Sheet for the product concerned, copies of which will be supplied on request.

**BUILDING TRUST**



Sika approved protection layer  
Sika Hydrotech Monolithic Membrane 6125

Sika Hydrotech Flex-Flash F laps over Sika Hydrotech Flex-Flash UN

Sika Hydrotech Flex-Flash UN laps into drain clamp area

Sika Hydrotech Monolithic Membrane 6125 on Sika Hydrotech Surface Conditioner 56170

Concrete substrate

### AquaKnight Drainage Outlet

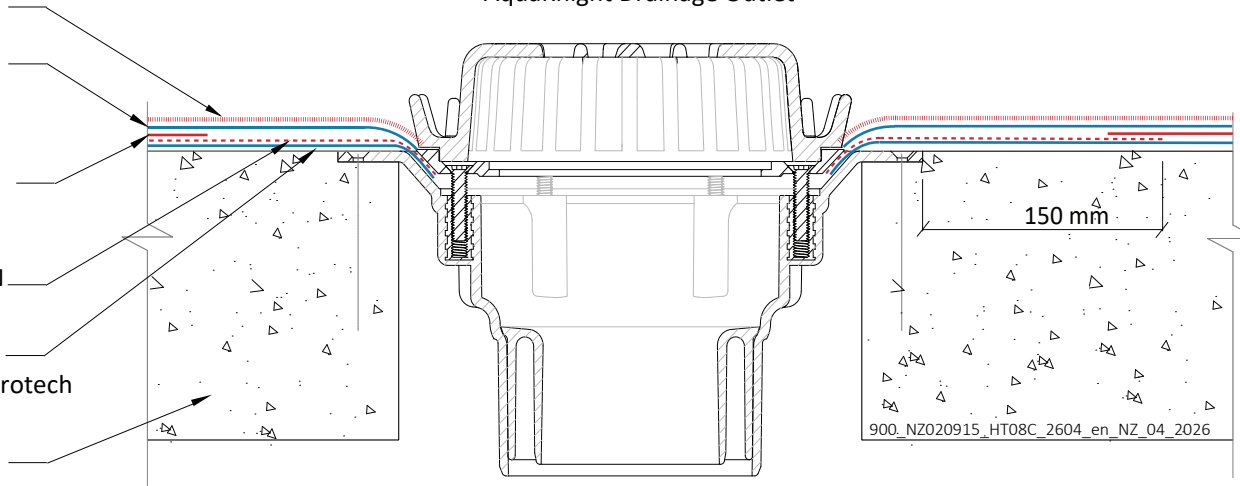

Notes:  
Sika Hydrotech Monolithic Membrane 6125 must be overlaid with a Sika Approved Protection Layer or Hydroflex 30.

Sika approved protection layer  
Sika Hydrotech Monolithic Membrane 6125

Sika Hydrotech Flex-Flash F laps over Sika Hydrotech Flex-Flash UN

Sika Hydrotech Flex-Flash UN laps into drain clamp area

Sika Hydrotech Monolithic Membrane 6125 on Sika Hydrotech Surface Conditioner 56170

Concrete substrate

### AquaKnight Overflow

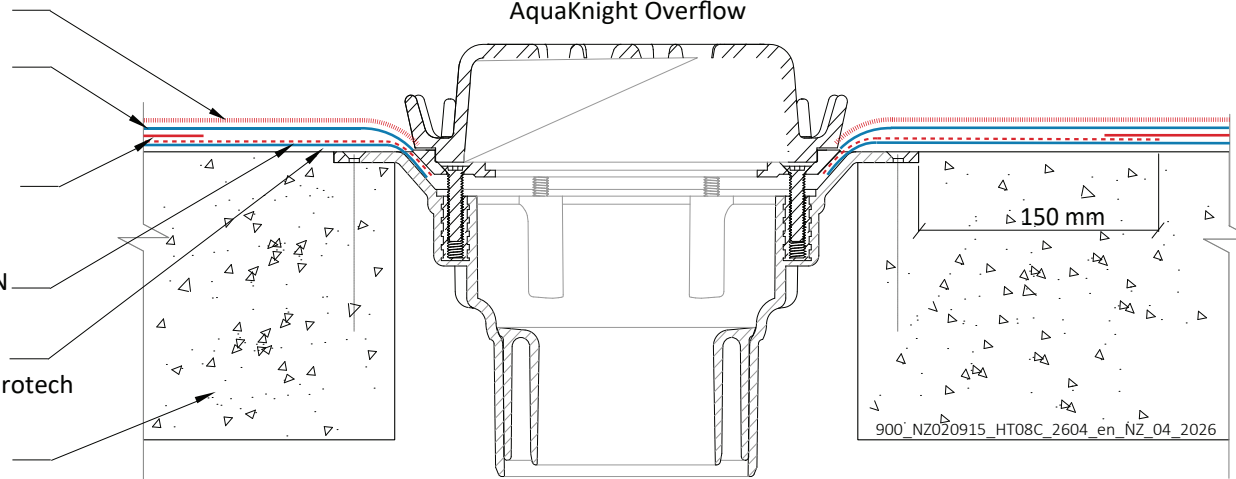

### Overflow Insert

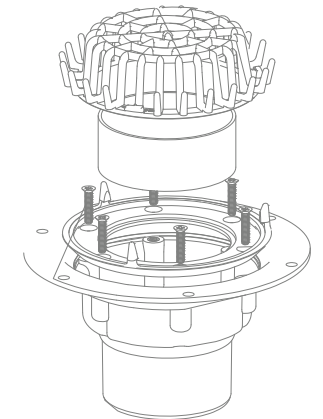

## SIKA HYDROTECH MONOLITHIC MEMBRANE 6125

### Outlet and Overflow Connection Details

General Detail. Not to scale.

DRAWING MUST ALWAYS BE REVIEWED BY A DESIGN SPECIALIST AND IF NECESSARY MODIFIED TO ENSURE SUITABILITY FOR THE SPECIFIC APPLICATION

The information contained herein and any other advice are given in good faith based on Sika's current knowledge and experience of the products when properly stored, handled and applied under normal conditions in accordance with Sika's recommendations. The information only applies to the application(s) and product(s) expressly referred to herein and is based on laboratory tests which do not replace practical tests. In case of changes in the parameters of the application, such as changes in substrates etc., or in case of a different application, consult Sika's Technical Service prior to using Sika products. The information contained herein does not relieve the user of the products from testing them for the intended application and purpose. All orders are accepted subject to our current terms of sale and delivery. Users must always refer to the most recent issue of the local Product Data Sheet for the product concerned, copies of which will be supplied on request.

900\_NZ020915\_HT08C\_2604\_en\_NZ\_04\_2026

April 2026

Sika (NZ) Ltd

85 Patiki Road

Auckland 1026

New Zealand.

Ph. 0800 745 269

www.sika.co.nz

**BUILDING TRUST**



Notes:  
 Sika Hydrotech Monolithic Membrane 6125 must be overlaid with a Sika Approved Protection Layer or Hydroflex 30.

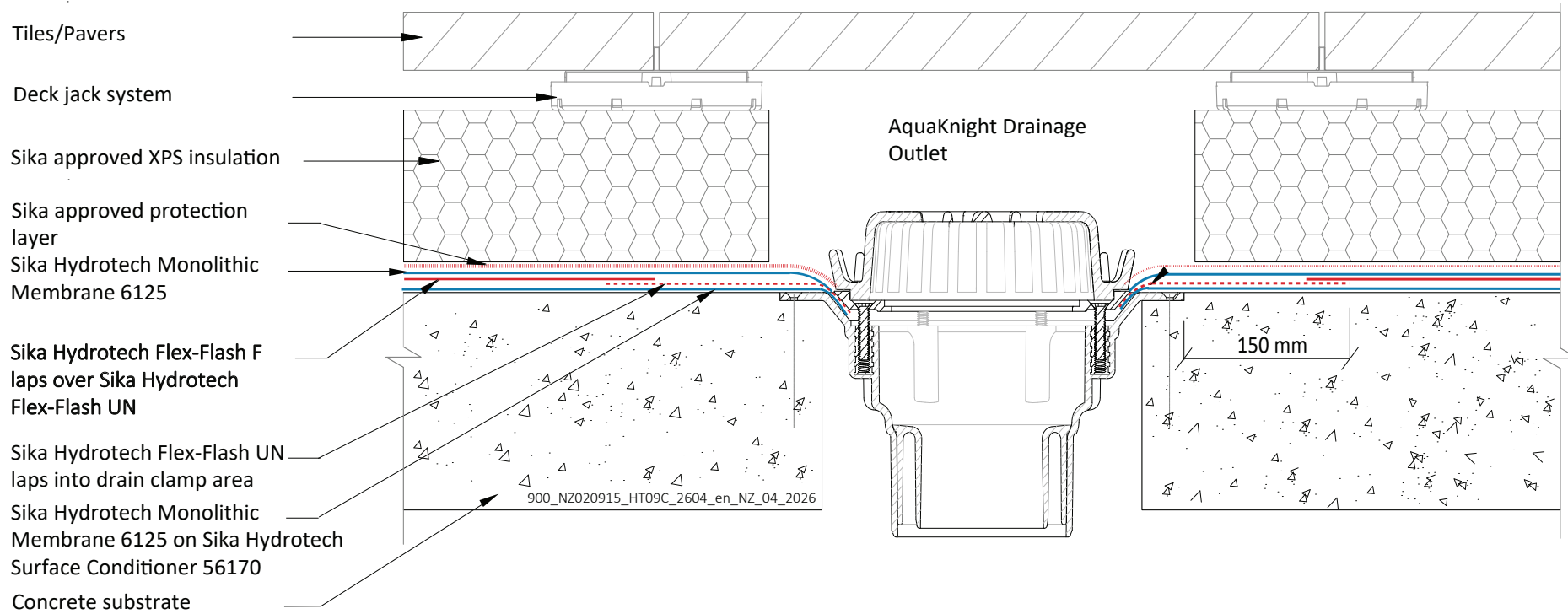

**SIKA HYDROTECH MONOLITHIC MEMBRANE 6125**

Outlet Connection Details- PMR Roof or Deck

General Detail. Not to scale.

DRAWING MUST ALWAYS BE REVIEWED BY A DESIGN SPECIALIST AND IF NECESSARY MODIFIED TO ENSURE SUITABILITY FOR THE SPECIFIC APPLICATION

The information contained herein and any other advice are given in good faith based on Sika's current knowledge and experience of the products when properly stored, handled and applied under normal conditions in accordance with Sika's recommendations. The information only applies to the application(s) and product(s) expressly referred to herein and is based on laboratory tests which do not replace practical tests. In case of changes in the parameters of the application, such as changes in substrates etc., or in case of a different application, consult Sika's Technical Service prior to using Sika products. The information contained herein does not relieve the user of the products from testing them for the intended application and purpose. All orders are accepted subject to our current terms of sale and delivery. Users must always refer to the most recent issue of the local Product Data Sheet for the product concerned, copies of which will be supplied on request.

900\_NZ020915\_HT09C\_2604\_en\_NZ\_04\_2026

April 2026

**Sika (NZ) Ltd**

85 Patiki Road

Auckland 1026

New Zealand.

Ph. 0800 745 269

www.sika.co.nz

**BUILDING TRUST**



Notes:  
 Sika Hydrotech Monolithic Membrane 6125 must be overlaid with a Sika Approved Protection Layer or Hydroflex 30.

Refer to Sika General Detail  
 900\_NZ020915\_HT08C for a standard outlet/overflow connection detail.

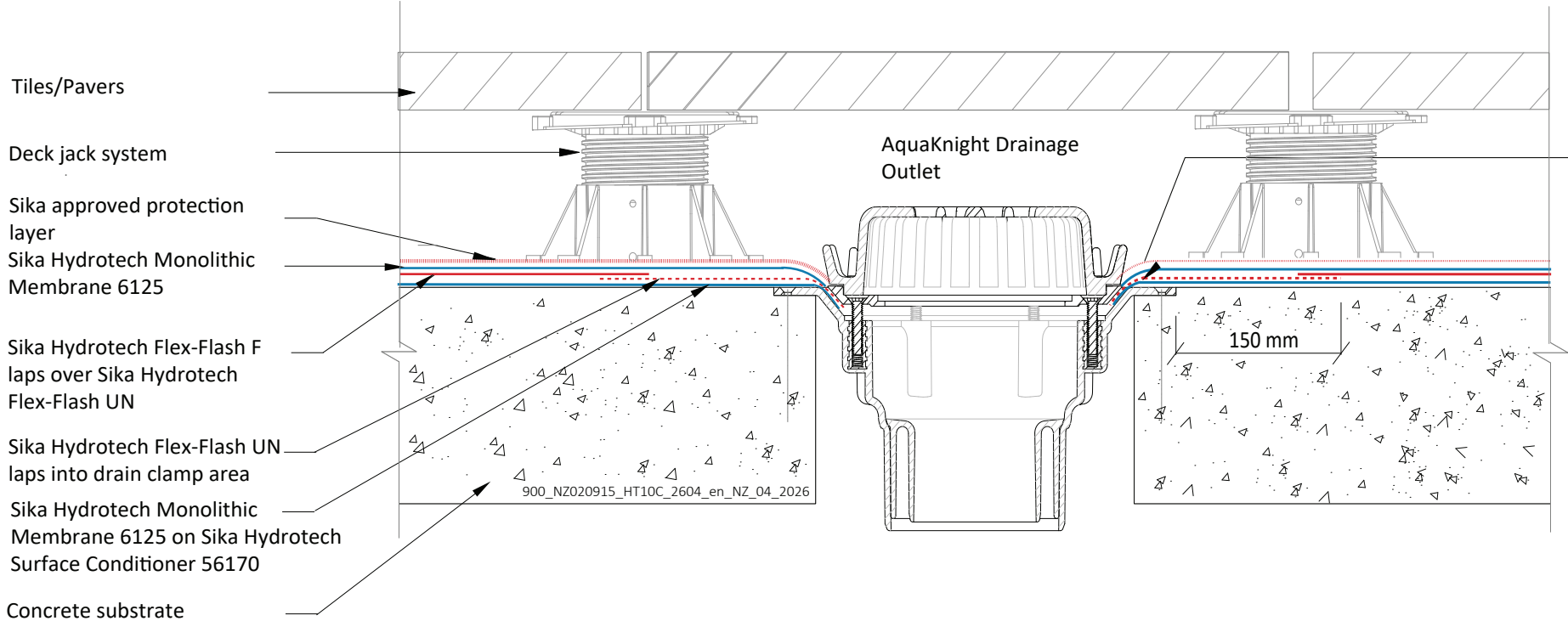

**SIKA HYDROTECH MONOLITHIC MEMBRANE 6125**  
 Outlet Connection Details- Cold Roof or Deck

General Detail. Not to scale.

900\_NZ020915\_HT10C\_2604\_en\_NZ\_04\_2026  
 April 2026

**Sika (NZ) Ltd**  
 85 Patiki Road  
 Auckland 1026  
 New Zealand.  
 Ph. 0800 745 269  
 www.sika.co.nz



DRAWING MUST ALWAYS BE REVIEWED BY A DESIGN SPECIALIST AND IF NECESSARY MODIFIED TO ENSURE SUITABILITY FOR THE SPECIFIC APPLICATION  
 The information contained herein and any other advice are given in good faith based on Sika's current knowledge and experience of the products when properly stored, handled and applied under normal conditions in accordance with Sika's recommendations. The information only applies to the application(s) and product(s) expressly referred to herein and is based on laboratory tests which do not replace practical tests. In case of changes in the parameters of the application, such as changes in substrates etc., or in case of a different application, consult Sika's Technical Service prior to using Sika products. The information contained herein does not relieve the user of the products from testing them for the intended application and purpose. All orders are accepted subject to our current terms of sale and delivery. Users must always refer to the most recent issue of the local Product Data Sheet for the product concerned, copies of which will be supplied on request.

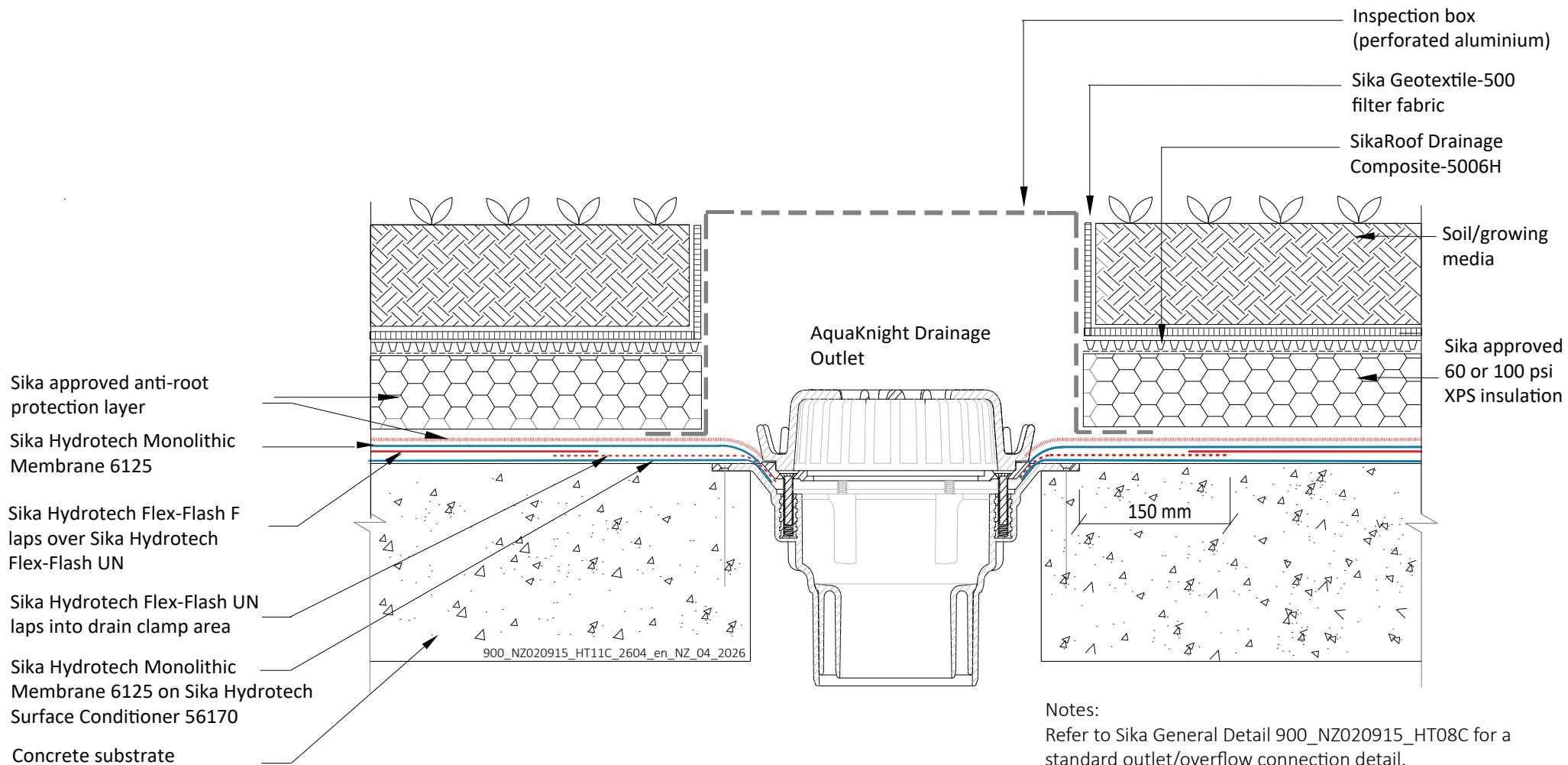

Notes:  
 Refer to Sika General Detail 900\_NZ020915\_HT08C for a standard outlet/overflow connection detail.

**SIKA HYDROTECH MONOLITHIC MEMBRANE 6125**

**Outlet Connection Details- PMR/Green Roof**

General Detail. Not to scale.

DRAWING MUST ALWAYS BE REVIEWED BY A DESIGN SPECIALIST AND IF NECESSARY MODIFIED TO ENSURE SUITABILITY FOR THE SPECIFIC APPLICATION

The information contained herein and any other advice are given in good faith based on Sika's current knowledge and experience of the products when properly stored, handled and applied under normal conditions in accordance with Sika's recommendations. The information only applies to the application(s) and product(s) expressly referred to herein and is based on laboratory tests which do not replace practical tests. In case of changes in the parameters of the application, such as changes in substrates etc., or in case of a different application, consult Sika's Technical Service prior to using Sika products. The information contained herein does not relieve the user of the products from testing them for the intended application and purpose. All orders are accepted subject to our current terms of sale and delivery. Users must always refer to the most recent issue of the local Product Data Sheet for the product concerned, copies of which will be supplied on request.

900\_NZ020915\_HT11C\_2604\_en\_NZ\_04\_2026

April 2026

**Sika (NZ) Ltd**

85 Patiki Road

Auckland 1026

New Zealand.

Ph. 0800 745 269

www.sika.co.nz

**BUILDING TRUST**



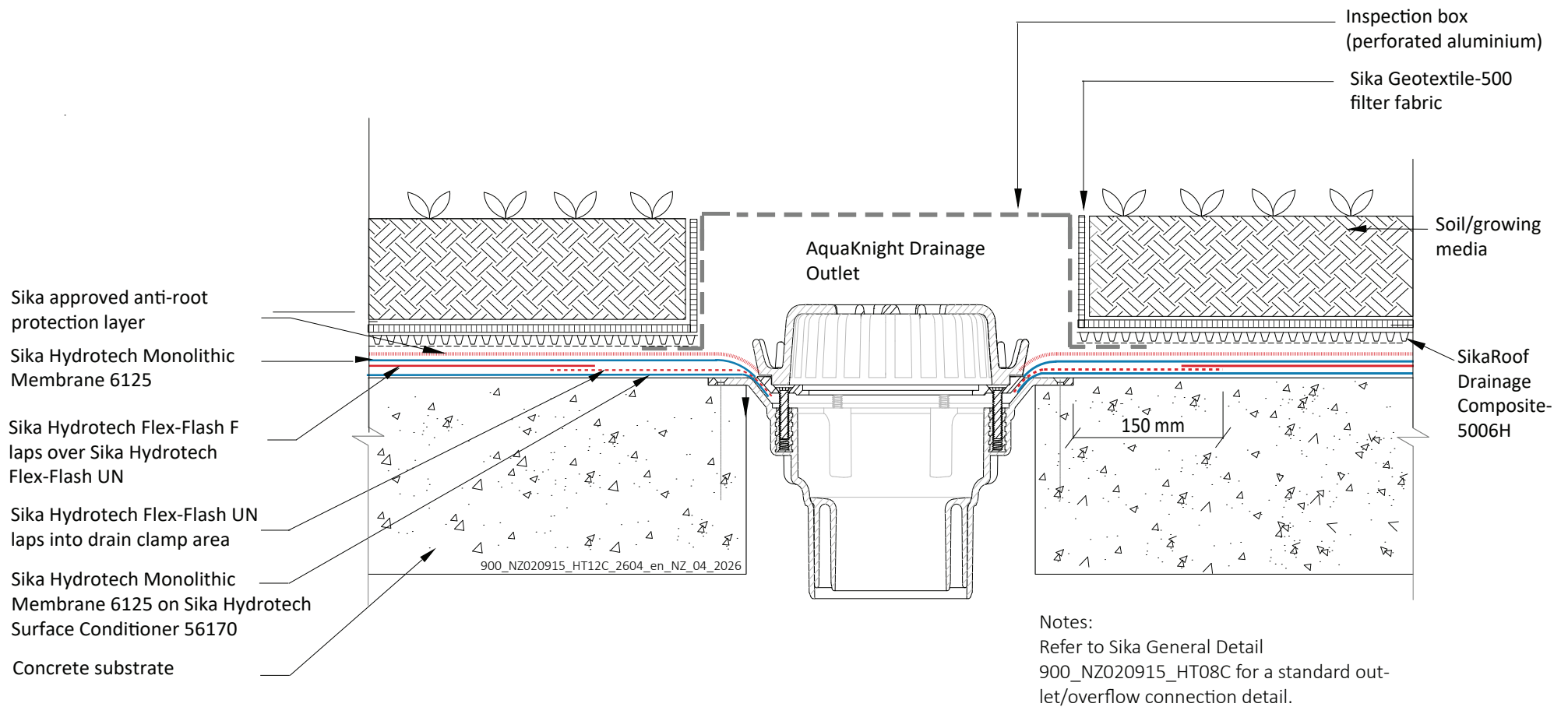

**SIKA HYDROTECH MONOLITHIC MEMBRANE 6125**  
 Outlet Connection Details- Cold or Green Roof, no XPS insulation  
 General Detail. Not to scale.

900\_NZ020915\_HT12C\_2604\_en\_NZ\_04\_2026  
 April 2026

**Sika (NZ) Ltd**  
 85 Patiki Road  
 Auckland 1026  
 New Zealand.  
 Ph. 0800 745 269  
 www.sika.co.nz



DRAWING MUST ALWAYS BE REVIEWED BY A DESIGN SPECIALIST AND IF NECESSARY MODIFIED TO ENSURE SUITABILITY FOR THE SPECIFIC APPLICATION  
 The information contained herein and any other advice are given in good faith based on Sika's current knowledge and experience of the products when properly stored, handled and applied under normal conditions in accordance with Sika's recommendations. The information only applies to the application(s) and product(s) expressly referred to herein and is based on laboratory tests which do not replace practical tests. In case of changes in the parameters of the application, such as changes in substrates etc., or in case of a different application, consult Sika's Technical Service prior to using Sika products. The information contained herein does not relieve the user of the products from testing them for the intended application and purpose. All orders are accepted subject to our current terms of sale and delivery. Users must always refer to the most recent issue of the local Product Data Sheet for the product concerned, copies of which will be supplied on request.

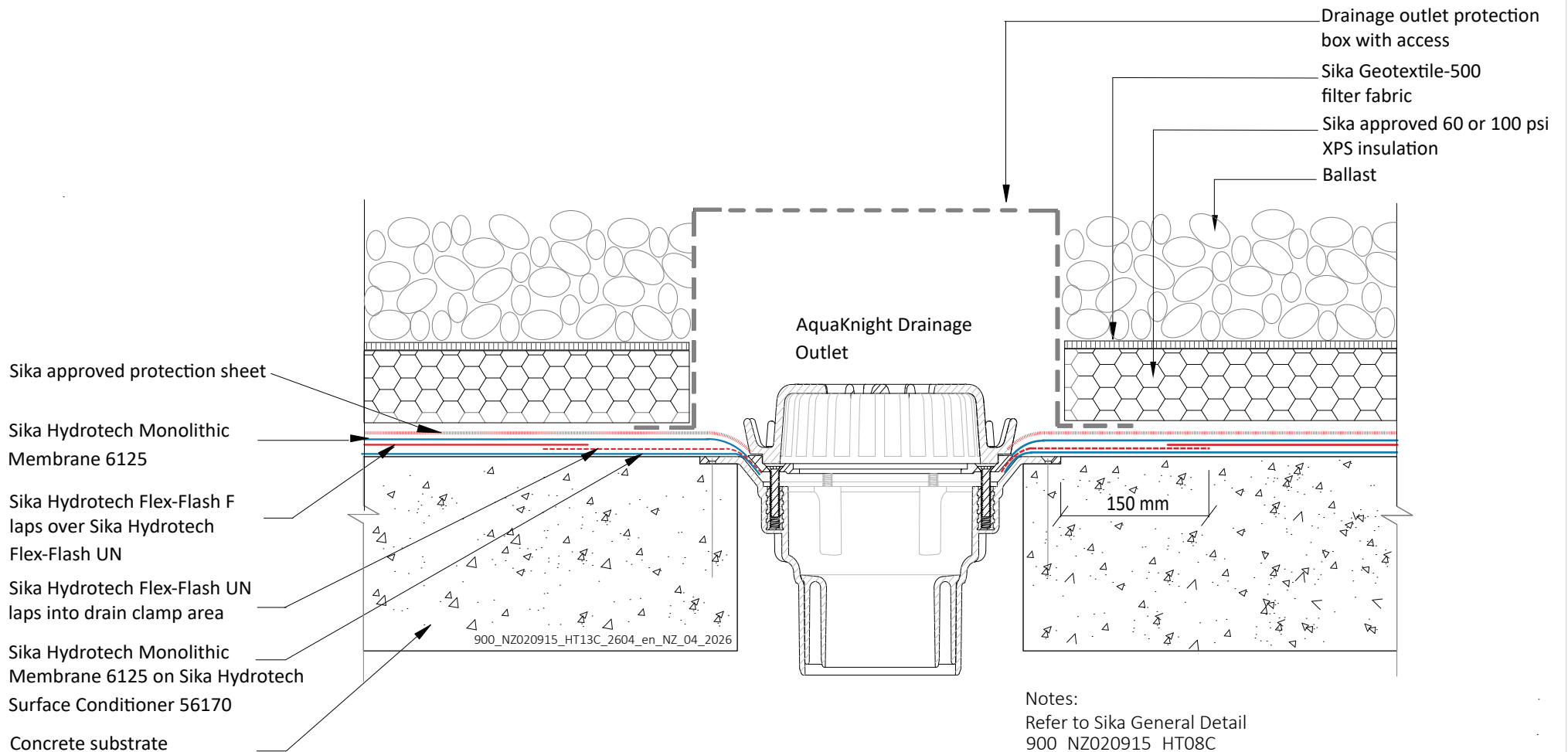

Notes:  
 Refer to Sika General Detail  
 900\_NZ020915\_HT08C  
 for a standard outlet/overflow  
 connection detail.

**SIKA HYDROTECH MONOLITHIC MEMBRANE 6125**  
 Outlet Connection Details- PMR/Ballast Roof

General Detail. Not to scale.

900\_NZ020915\_HT13C\_2604\_en\_NZ\_04\_2026

April 2026

**Sika (NZ) Ltd**

85 Patiki Road

Auckland 1026

New Zealand.

Ph. 0800 745 269

www.sika.co.nz

**BUILDING TRUST**



DRAWING MUST ALWAYS BE REVIEWED BY A DESIGN SPECIALIST AND IF NECESSARY MODIFIED TO ENSURE SUITABILITY FOR THE SPECIFIC APPLICATION  
 The information contained herein and any other advice are given in good faith based on Sika's current knowledge and experience of the products when properly stored, handled and applied under normal conditions in accordance with Sika's recommendations. The information only applies to the application(s) and product(s) expressly referred to herein and is based on laboratory tests which do not replace practical tests. In case of changes in the parameters of the application, such as changes in substrates etc., or in case of a different application, consult Sika's Technical Service prior to using Sika products. The information contained herein does not relieve the user of the products from testing them for the intended application and purpose. All orders are accepted subject to our current terms of sale and delivery. Users must always refer to the most recent issue of the local Product Data Sheet for the product concerned, copies of which will be supplied on request.

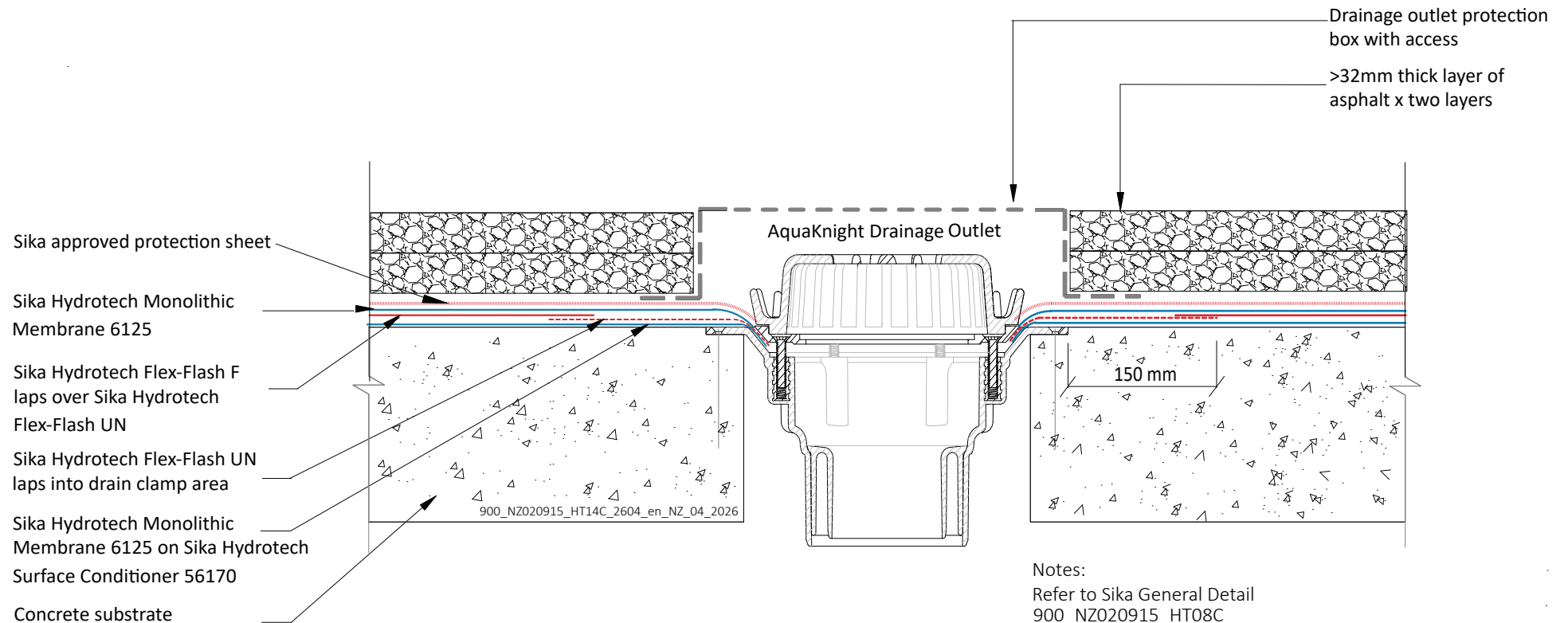

Notes:  
 Refer to Sika General Detail  
 900\_NZ020915\_HT08C  
 for a standard outlet/overflow  
 connection detail.

**SIKA HYDROTECH MONOLITHIC MEMBRANE 6125**  
 Outlet Connection Details- Cold Roof with Asphalt Overlay

General Detail. Not to scale.

DRAWING MUST ALWAYS BE REVIEWED BY A DESIGN SPECIALIST AND IF NECESSARY MODIFIED TO ENSURE SUITABILITY FOR THE SPECIFIC APPLICATION  
 The information contained herein and any other advice are given in good faith based on Sika's current knowledge and experience of the products when properly stored, handled and applied under normal conditions in accordance with Sika's recommendations. The information only applies to the application(s) and product(s) expressly referred to herein and is based on laboratory tests which do not replace practical tests. In case of changes in the parameters of the application, such as changes in substrates etc., or in case of a different application, consult Sika's Technical Service prior to using Sika products. The information contained herein does not relieve the user of the products from testing them for the intended application and purpose. All orders are accepted subject to our current terms of sale and delivery. Users must always refer to the most recent issue of the local Product Data Sheet for the product concerned, copies of which will be supplied on request.

900\_NZ020915\_HT14C\_2604\_en\_NZ\_04\_2026  
 April 2026

**Sika (NZ) Ltd**  
 85 Patiki Road  
 Auckland 1026  
 New Zealand.  
 Ph. 0800 745 269  
 www.sika.co.nz

**BUILDING TRUST**



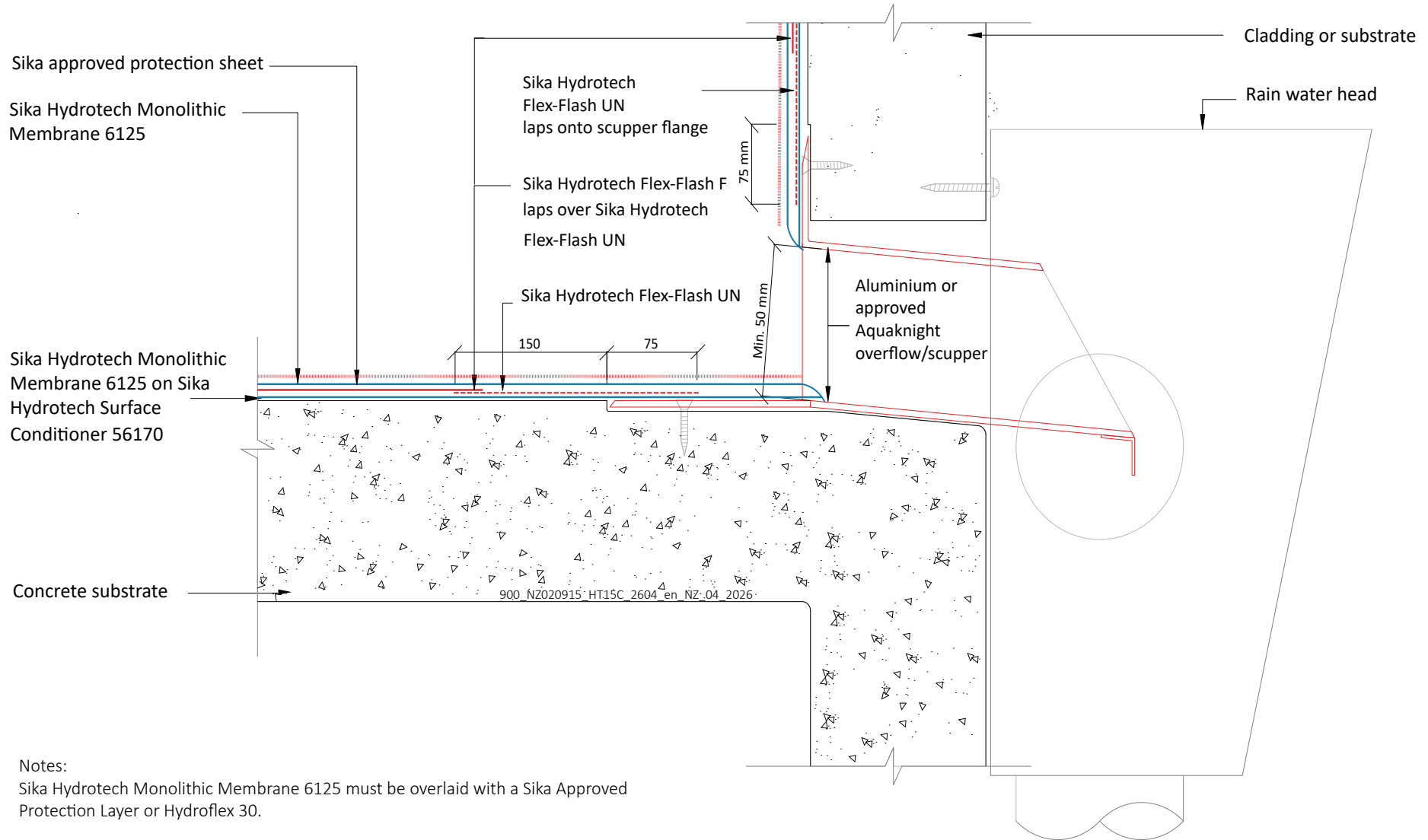

Notes:  
Sika Hydrotech Monolithic Membrane 6125 must be overlaid with a Sika Approved Protection Layer or Hydroflex 30.

**SIKA HYDROTECH MONOLITHIC MEMBRANE 6125**  
Outlet Connection Details - Outlet / Scupper

General Detail. Not to scale.

DRAWING MUST ALWAYS BE REVIEWED BY A DESIGN SPECIALIST AND IF NECESSARY MODIFIED TO ENSURE SUITABILITY FOR THE SPECIFIC APPLICATION

The information contained herein and any other advice are given in good faith based on Sika's current knowledge and experience of the products when properly stored, handled and applied under normal conditions in accordance with Sika's recommendations. The information only applies to the application(s) and product(s) expressly referred to herein and is based on laboratory tests which do not replace practical tests. In case of changes in the parameters of the application, such as changes in substrates etc., or in case of a different application, consult Sika's Technical Service prior to using Sika products. The information contained herein does not relieve the user of the products from testing them for the intended application and purpose. All orders are accepted subject to our current terms of sale and delivery. Users must always refer to the most recent issue of the local Product Data Sheet for the product concerned, copies of which will be supplied on request.

900\_NZ020915\_HT14C\_2604\_en\_NZ\_04\_2026

April 2026

**Sika (NZ) Ltd**

85 Patiki Road  
Auckland 1026  
New Zealand.

Ph. 0800 745 269

www.sika.co.nz

**BUILDING TRUST**



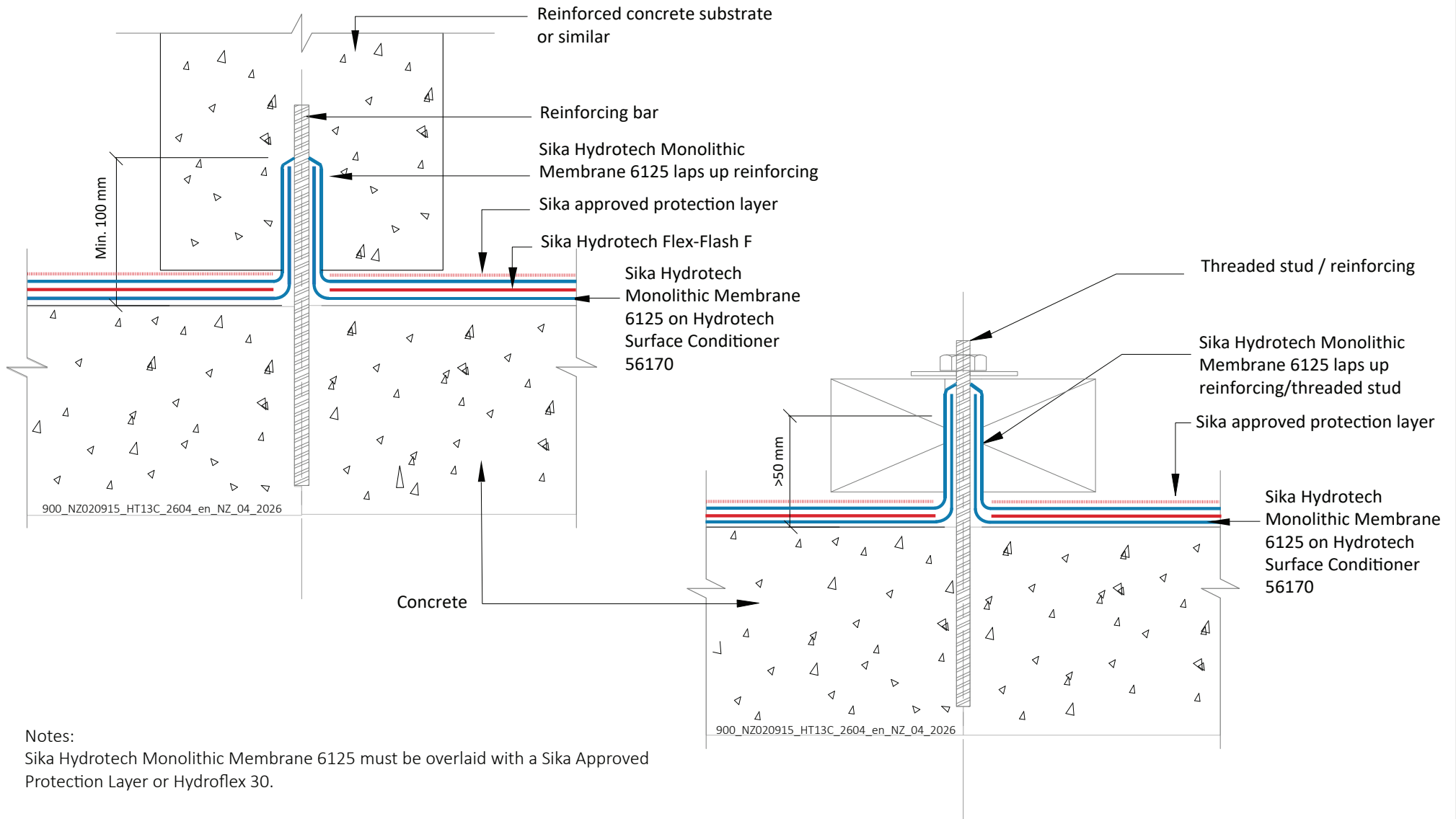

Notes:  
 Sika Hydrotech Monolithic Membrane 6125 must be overlaid with a Sika Approved Protection Layer or Hydroflex 30.

**SIKA HYDROTECH MONOLITHIC MEMBRANE 6125**

Penetrations, Option One

General Detail. Not to scale.

900\_NZ020915\_HT13C\_2604\_en\_NZ\_04\_2026

April 2026

Sika (NZ) Ltd

85 Patiki Road

Auckland 1026

New Zealand.

Ph. 0800 745 269

www.sika.co.nz

DRAWING MUST ALWAYS BE REVIEWED BY A DESIGN SPECIALIST AND IF NECESSARY MODIFIED TO ENSURE SUITABILITY FOR THE SPECIFIC APPLICATION  
 The information contained herein and any other advice are given in good faith based on Sika's current knowledge and experience of the products when properly stored, handled and applied under normal conditions in accordance with Sika's recommendations. The information only applies to the application(s) and product(s) expressly referred to herein and is based on laboratory tests which do not replace practical tests. In case of changes in the parameters of the application, such as changes in substrates etc., or in case of a different application, consult Sika's Technical Service prior to using Sika products. The information contained herein does not relieve the user of the products from testing them for the intended application and purpose. All orders are accepted subject to our current terms of sale and delivery. Users must always refer to the most recent issue of the local Product Data Sheet for the product concerned, copies of which will be supplied on request.



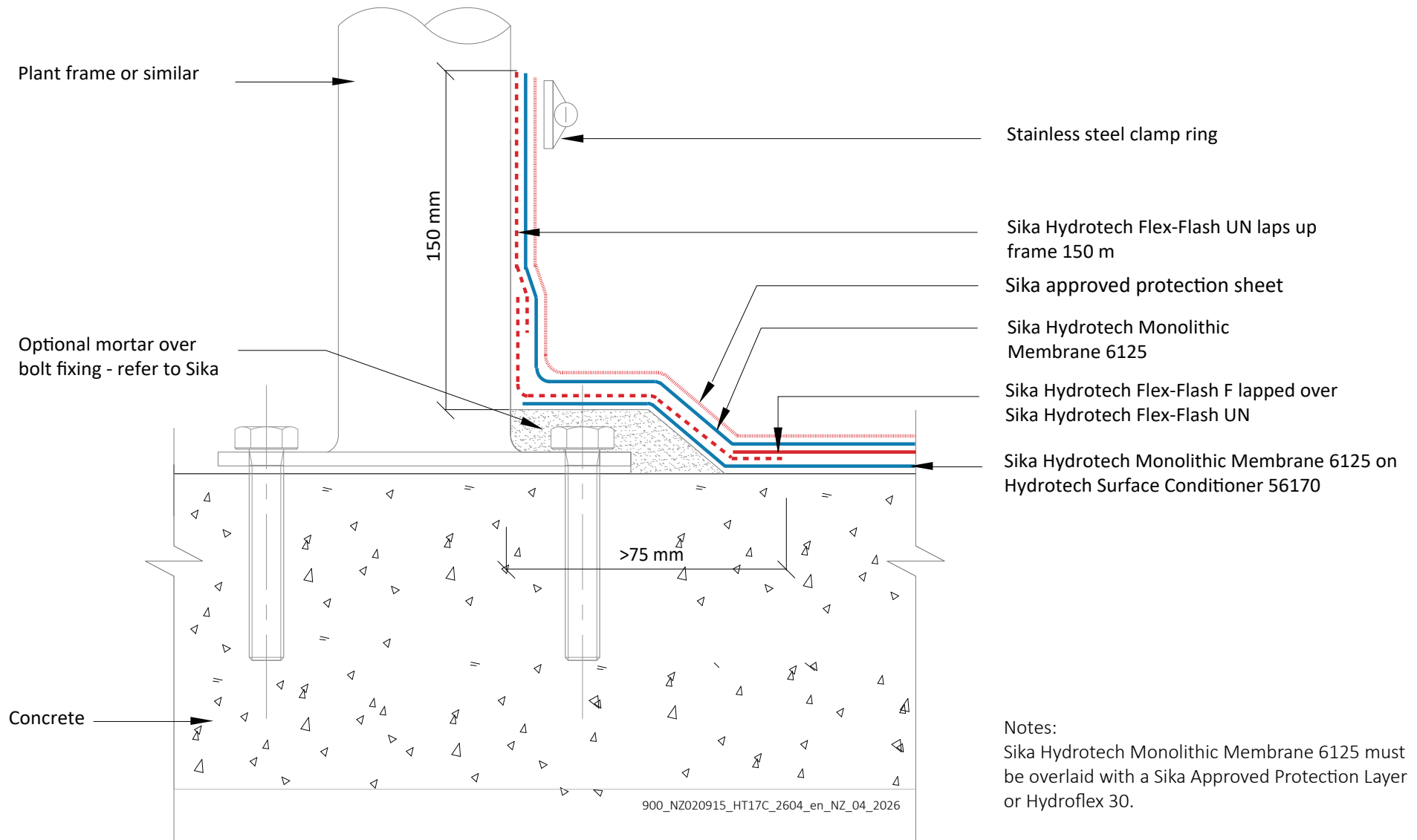

Notes:  
 Sika Hydrotech Monolithic Membrane 6125 must be overlaid with a Sika Approved Protection Layer or Hydroflex 30.

**SIKA HYDROTECH MONOLITHIC MEMBRANE 6125**

**Penetration Detail- Plantwork**

General Detail. Not to scale.

900\_NZ020915\_HT17C\_2604\_en\_NZ\_04\_2026

April 2026

Sika (NZ) Ltd

85 Patiki Road

Auckland 1026

New Zealand.

Ph. 0800 745 269

www.sika.co.nz

DRAWING MUST ALWAYS BE REVIEWED BY A DESIGN SPECIALIST AND IF NECESSARY MODIFIED TO ENSURE SUITABILITY FOR THE SPECIFIC APPLICATION

The information contained herein and any other advice are given in good faith based on Sika's current knowledge and experience of the products when properly stored, handled and applied under normal conditions in accordance with Sika's recommendations. The information only applies to the application(s) and product(s) expressly referred to herein and is based on laboratory tests which do not replace practical tests. In case of changes in the parameters of the application, such as changes in substrates etc., or in case of a different application, consult Sika's Technical Service prior to using Sika products. The information contained herein does not relieve the user of the products from testing them for the intended application and purpose. All orders are accepted subject to our current terms of sale and delivery. Users must always refer to the most recent issue of the local Product Data Sheet for the product concerned, copies of which will be supplied on request.

**BUILDING TRUST**



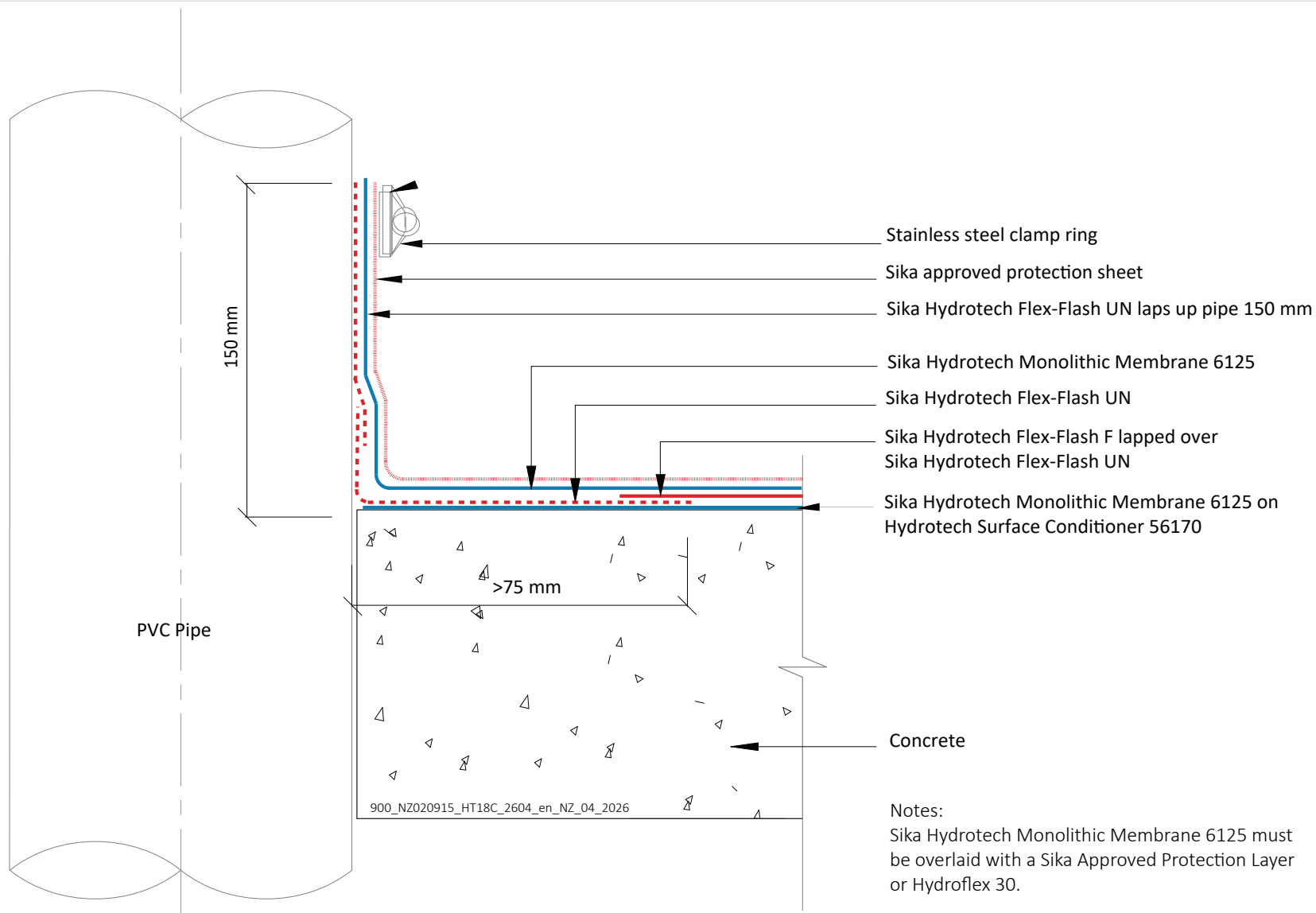

**SIKA HYDROTECH MONOLITHIC MEMBRANE 6125**

**Penetration Detail- Pipe**

General Detail. Not to scale.

DRAWING MUST ALWAYS BE REVIEWED BY A DESIGN SPECIALIST AND IF NECESSARY MODIFIED TO ENSURE SUITABILITY FOR THE SPECIFIC APPLICATION

The information contained herein and any other advice are given in good faith based on Sika's current knowledge and experience of the products when properly stored, handled and applied under normal conditions in accordance with Sika's recommendations. The information only applies to the application(s) and product(s) expressly referred to herein and is based on laboratory tests which do not replace practical tests. In case of changes in the parameters of the application, such as changes in substrates etc., or in case of a different application, consult Sika's Technical Service prior to using Sika products. The information contained herein does not relieve the user of the products from testing them for the intended application and purpose. All orders are accepted subject to our current terms of sale and delivery. Users must always refer to the most recent issue of the local Product Data Sheet for the product concerned, copies of which will be supplied on request.

900\_NZ020915\_HT18C\_2604\_en\_NZ\_04\_2026

April 2026

**Sika (NZ) Ltd**

85 Patiki Road

Auckland 1026

New Zealand.

Ph. 0800 745 269

www.sika.co.nz

**BUILDING TRUST**



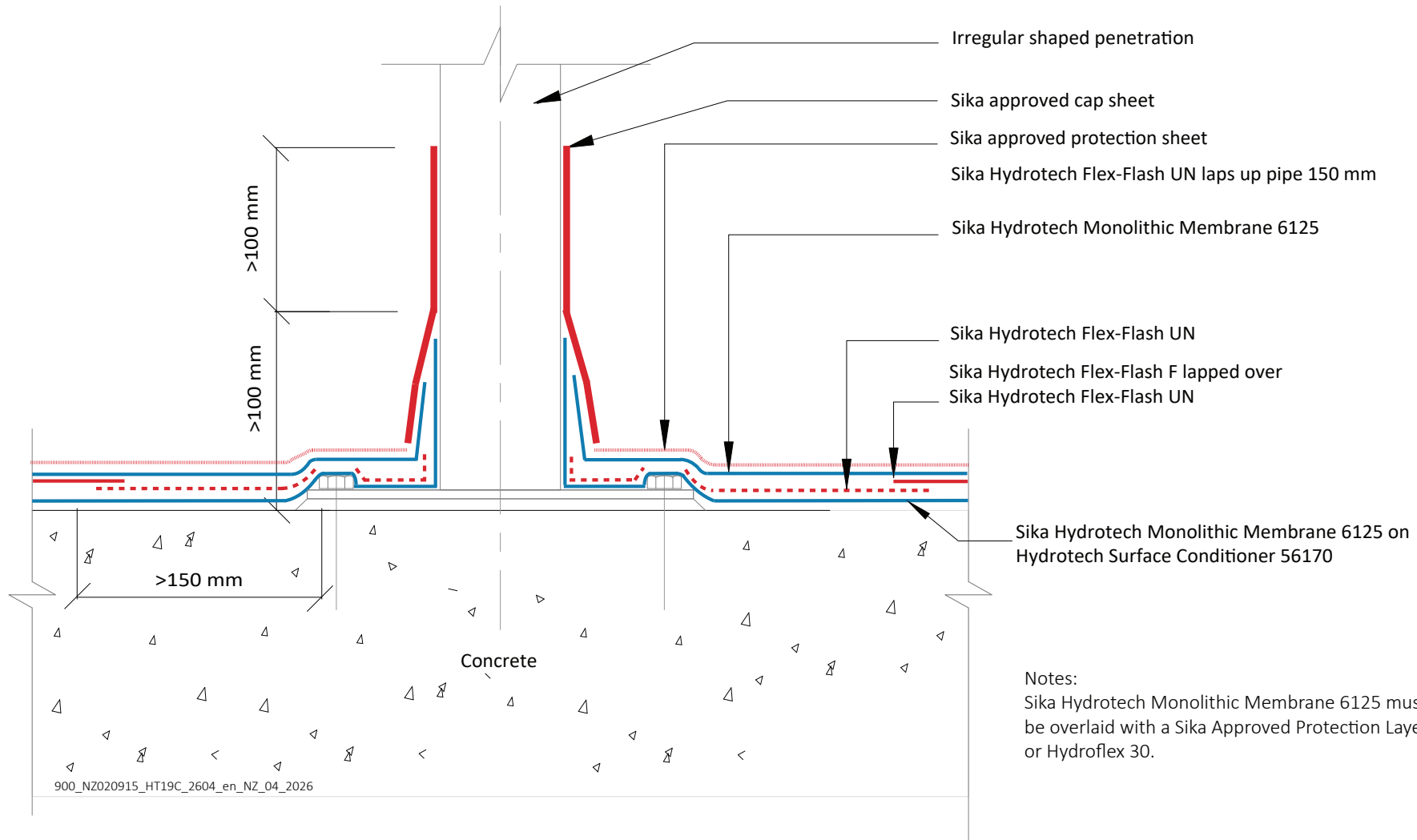

Notes:  
 Sika Hydrotech Monolithic Membrane 6125 must be overlaid with a Sika Approved Protection Layer or Hydroflex 30.

900\_NZ020915\_HT19C\_2604\_en\_NZ\_04\_2026

**SIKA HYDROTECH MONOLITHIC MEMBRANE 6125**

**Exposed Penetration Detail- Irregular**

General Detail. Not to scale.

DRAWING MUST ALWAYS BE REVIEWED BY A DESIGN SPECIALIST AND IF NECESSARY MODIFIED TO ENSURE SUITABILITY FOR THE SPECIFIC APPLICATION

The information contained herein and any other advice are given in good faith based on Sika's current knowledge and experience of the products when properly stored, handled and applied under normal conditions in accordance with Sika's recommendations. The information only applies to the application(s) and product(s) expressly referred to herein and is based on laboratory tests which do not replace practical tests. In case of changes in the parameters of the application, such as changes in substrates etc., or in case of a different application, consult Sika's Technical Service prior to using Sika products. The information contained herein does not relieve the user of the products from testing them for the intended application and purpose. All orders are accepted subject to our current terms of sale and delivery. Users must always refer to the most recent issue of the local Product Data Sheet for the product concerned, copies of which will be supplied on request.

900\_NZ020915\_HT19C\_2604\_en\_NZ\_04\_2026

April 2026

**Sika (NZ) Ltd**

85 Patiki Road

Auckland 1026

New Zealand.

Ph. 0800 745 269

www.sika.co.nz

**BUILDING TRUST**



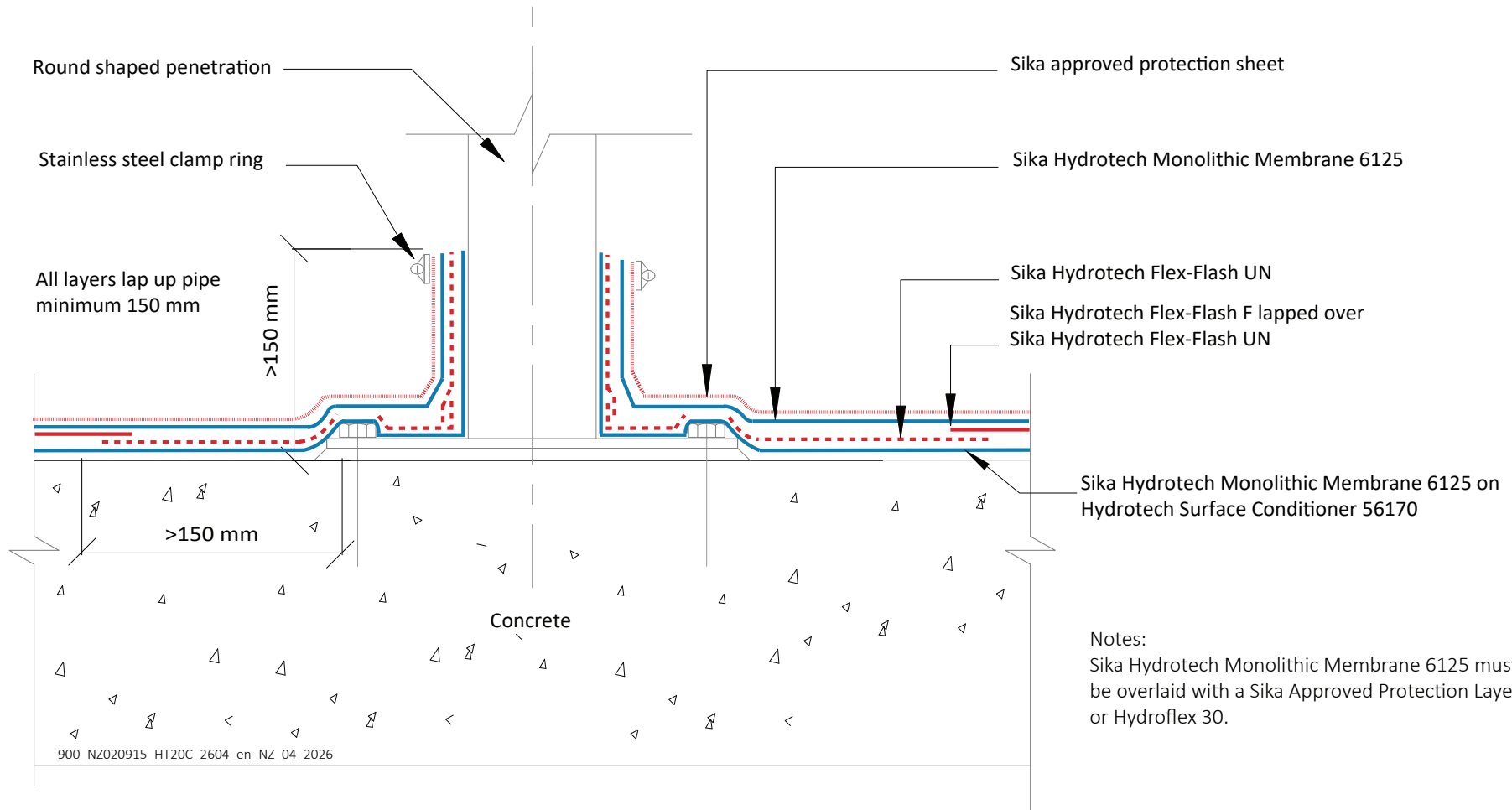

Notes:  
 Sika Hydrotech Monolithic Membrane 6125 must be overlaid with a Sika Approved Protection Layer or Hydroflex 30.

900\_NZ020915\_HT20C\_2604\_en\_NZ\_04\_2026

**SIKA HYDROTECH MONOLITHIC MEMBRANE 6125**

**Penetration Detail- Round shaped penetration**

General Detail. Not to scale.

900\_NZ020915\_HT20C\_2604\_en\_NZ\_04\_2026

April 2026

**Sika (NZ) Ltd**

85 Patiki Road  
 Auckland 1026  
 New Zealand.

Ph. 0800 745 269

www.sika.co.nz

**BUILDING TRUST**



DRAWING MUST ALWAYS BE REVIEWED BY A DESIGN SPECIALIST AND IF NECESSARY MODIFIED TO ENSURE SUITABILITY FOR THE SPECIFIC APPLICATION  
 The information contained herein and any other advice are given in good faith based on Sika's current knowledge and experience of the products when properly stored, handled and applied under normal conditions in accordance with Sika's recommendations. The information only applies to the application(s) and product(s) expressly referred to herein and is based on laboratory tests which do not replace practical tests. In case of changes in the parameters of the application, such as changes in substrates etc., or in case of a different application, consult Sika's Technical Service prior to using Sika products. The information contained herein does not relieve the user of the products from testing them for the intended application and purpose. All orders are accepted subject to our current terms of sale and delivery. Users must always refer to the most recent issue of the local Product Data Sheet for the product concerned, copies of which will be supplied on request.

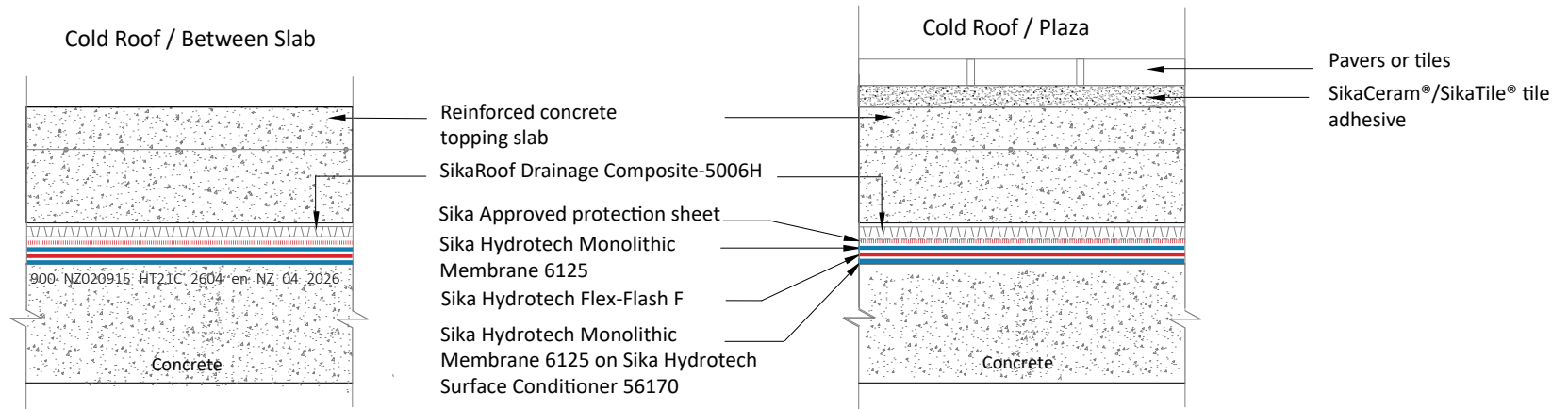
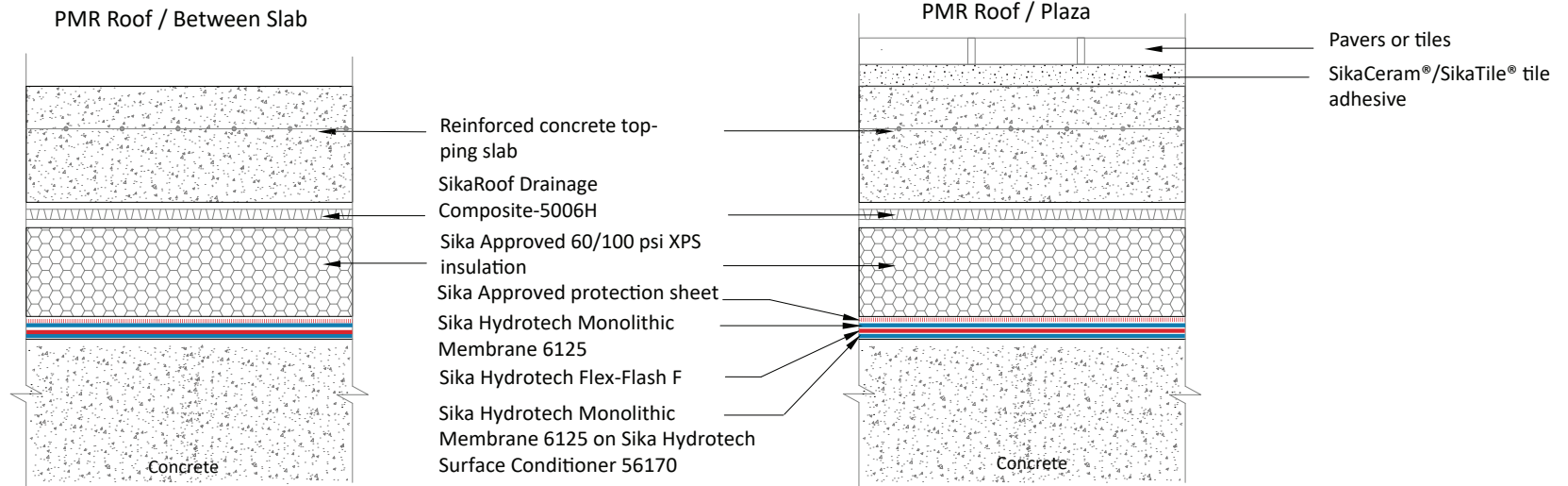

Notes:  
Sika Hydrotech Monolithic Membrane 6125 must be overlaid with a Sika Approved Protection Layer or Hydroflex 30.

**SIKA HYDROTECH MONOLITHIC MEMBRANE 6125**

PMR Roof or Cold Roof, paver and trafficable options

General Detail. Not to scale.

900\_NZ020915\_HT21C\_2604\_en\_NZ\_04\_2026

April 2026

Sika (NZ) Ltd

85 Patiki Road

Auckland 1026

New Zealand.

Ph. 0800 745 269

www.sika.co.nz

DRAWING MUST ALWAYS BE REVIEWED BY A DESIGN SPECIALIST AND IF NECESSARY MODIFIED TO ENSURE SUITABILITY FOR THE SPECIFIC APPLICATION  
The information contained herein and any other advice are given in good faith based on Sika's current knowledge and experience of the products when properly stored, handled and applied under normal conditions in accordance with Sika's recommendations. The information only applies to the application(s) and product(s) expressly referred to herein and is based on laboratory tests which do not replace practical tests. In case of changes in the parameters of the application, such as changes in substrates etc., or in case of a different application, consult Sika's Technical Service prior to using Sika products. The information contained herein does not relieve the user of the products from testing them for the intended application and purpose. All orders are accepted subject to our current terms of sale and delivery. Users must always refer to the most recent issue of the local Product Data Sheet for the product concerned, copies of which will be supplied on request.

**BUILDING TRUST**



**PMR Roof with Asphalt**

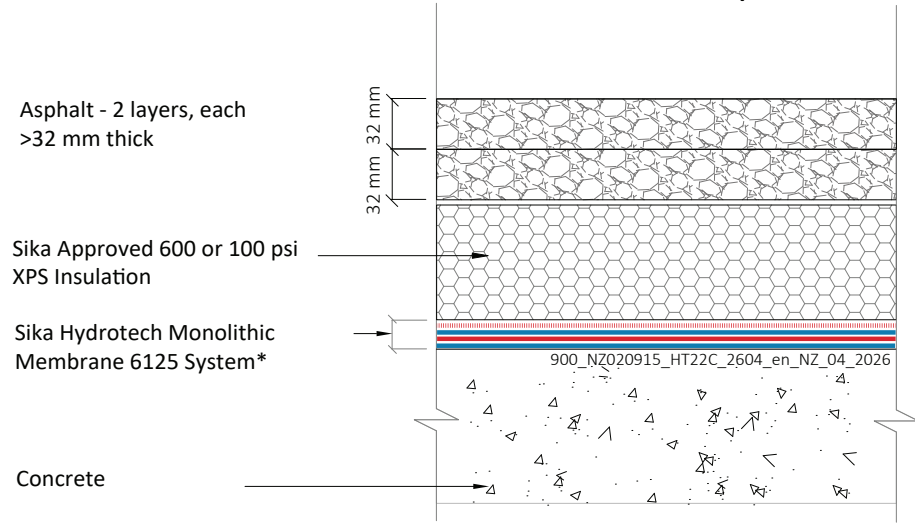

**Cold Roof with Asphalt over Hardfill**

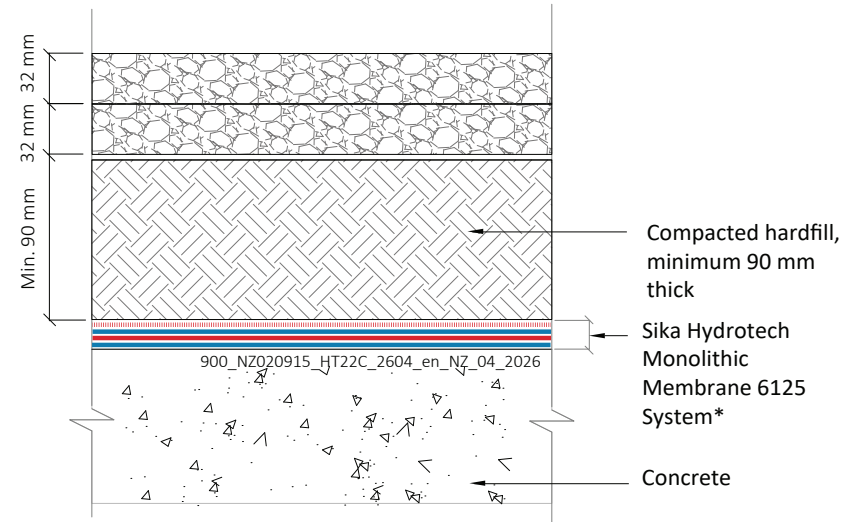

**Notes:**

Sika Hydrotech Monolithic Membrane 6125 must be overlaid with a Sika Approved Protection Layer or Hydroflex 30.

**Cold Roof with Asphalt**

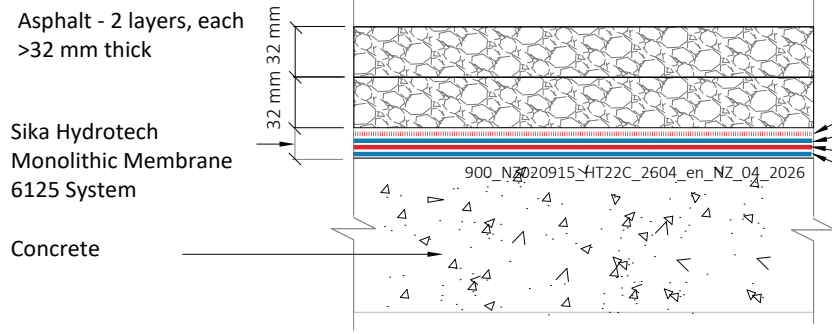

**\*System Structure:**

- Sika Approved protection sheet
- Sika Hydrotech Monolithic Membrane 6125
- Sika Hydrotech Flex-Flash F
- Sika Hydrotech Monolithic Membrane 6125 on Sika Hydrotech Surface Conditioner 56170

**SIKA HYDROTECH MONOLITHIC MEMBRANE 6125**

PMR Roof or Cold Roof, asphalt options

General Detail. Not to scale.

900\_NZ020915\_HT22C\_2604\_en\_NZ\_04\_2026

April 2026

**Sika (NZ) Ltd**

85 Patiki Road

Auckland 1026

New Zealand.

Ph. 0800 745 269

www.sika.co.nz

DRAWING MUST ALWAYS BE REVIEWED BY A DESIGN SPECIALIST AND IF NECESSARY MODIFIED TO ENSURE SUITABILITY FOR THE SPECIFIC APPLICATION

The information contained herein and any other advice are given in good faith based on Sika's current knowledge and experience of the products when properly stored, handled and applied under normal conditions in accordance with Sika's recommendations. The information only applies to the application(s) and product(s) expressly referred to herein and is based on laboratory tests which do not replace practical tests. In case of changes in the parameters of the application, such as changes in substrates etc., or in case of a different application, consult Sika's Technical Service prior to using Sika products. The information contained herein does not relieve the user of the products from testing them for the intended application and purpose. All orders are accepted subject to our current terms of sale and delivery. Users must always refer to the most recent issue of the local Product Data Sheet for the product concerned, copies of which will be supplied on request.

**BUILDING TRUST**



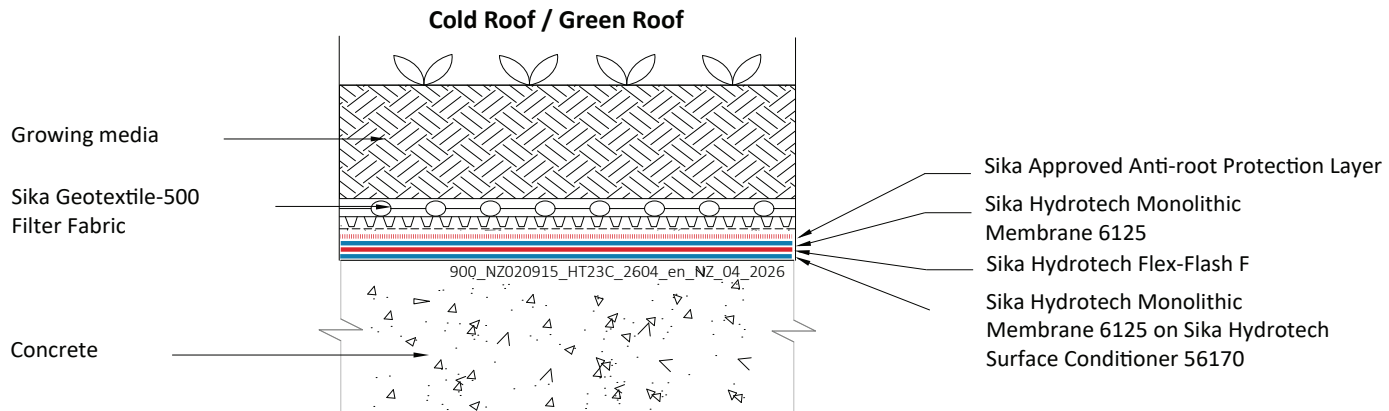
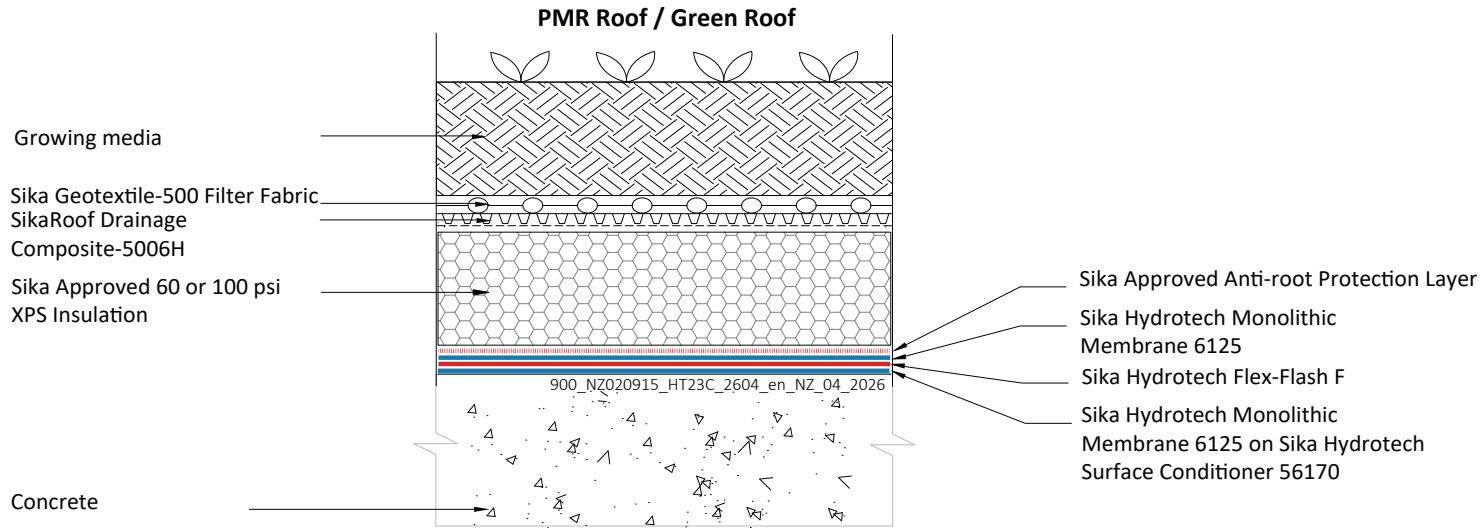

**SIKA HYDROTECH MONOLITHIC MEMBRANE 6125**

PMR Roof or Cold Roof, Green Roof Options

General Detail. Not to scale.

900\_NZ020915\_HT23C\_2604\_en\_NZ\_04\_2026

April 2026

**Sika (NZ) Ltd**

85 Patiki Road

Auckland 1026

New Zealand.

Ph. 0800 745 269

www.sika.co.nz

DRAWING MUST ALWAYS BE REVIEWED BY A DESIGN SPECIALIST AND IF NECESSARY MODIFIED TO ENSURE SUITABILITY FOR THE SPECIFIC APPLICATION  
The information contained herein and any other advice are given in good faith based on Sika's current knowledge and experience of the products when properly stored, handled and applied under normal conditions in accordance with Sika's recommendations. The information only applies to the application(s) and product(s) expressly referred to herein and is based on laboratory tests which do not replace practical tests. In case of changes in the parameters of the application, such as changes in substrates etc., or in case of a different application, consult Sika's Technical Service prior to using Sika products. The information contained herein does not relieve the user of the products from testing them for the intended application and purpose. All orders are accepted subject to our current terms of sale and delivery. Users must always refer to the most recent issue of the local Product Data Sheet for the product concerned, copies of which will be supplied on request.

**BUILDING TRUST**



**PMR Roof / Ballast Roof**

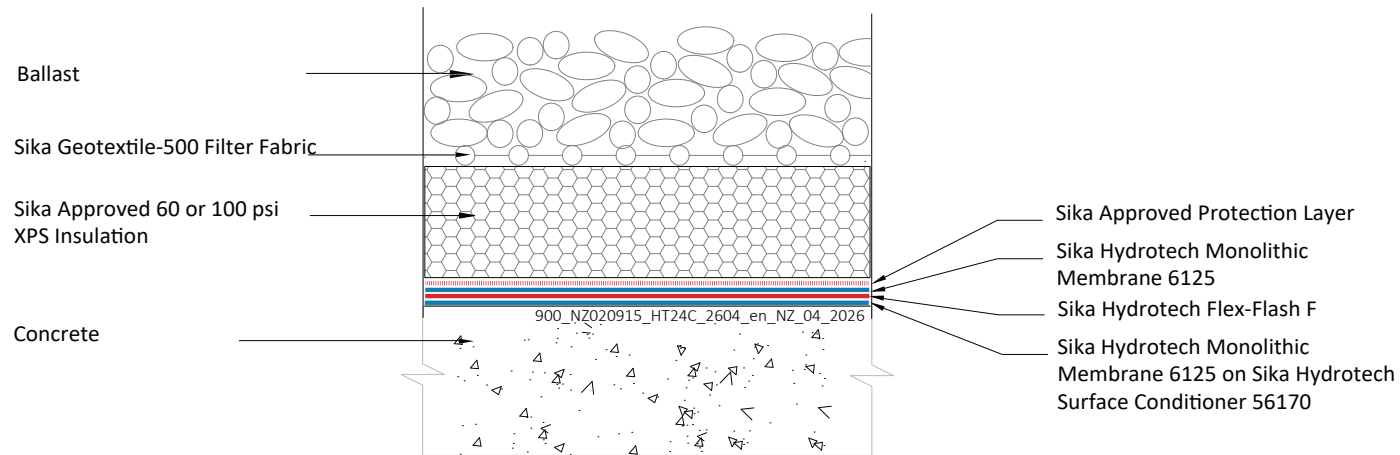

**Cold Roof / Ballast Roof**

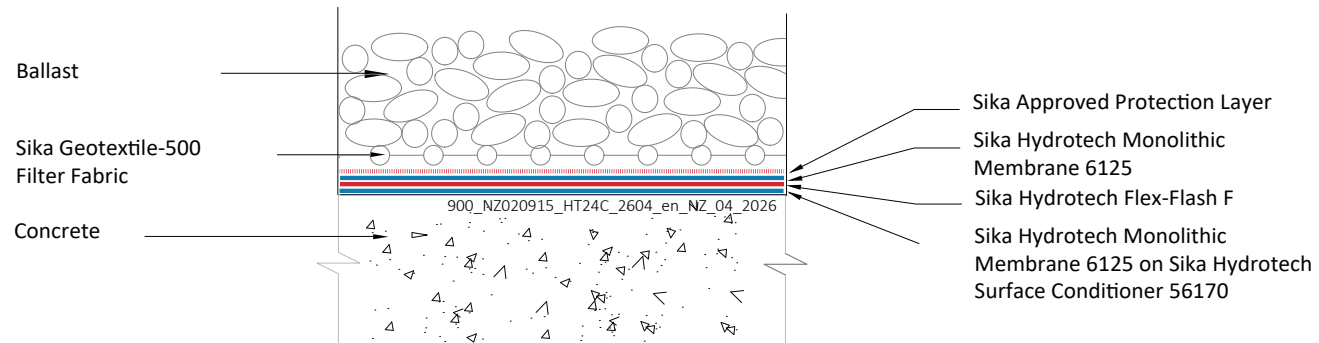

**SIKA HYDROTECH MONOLITHIC MEMBRANE 6125**

PMR Roof or Cold Roof, Ballast Roof Options

General Detail. Not to scale.

DRAWING MUST ALWAYS BE REVIEWED BY A DESIGN SPECIALIST AND IF NECESSARY MODIFIED TO ENSURE SUITABILITY FOR THE SPECIFIC APPLICATION

The information contained herein and any other advice are given in good faith based on Sika's current knowledge and experience of the products when properly stored, handled and applied under normal conditions in accordance with Sika's recommendations. The information only applies to the application(s) and product(s) expressly referred to herein and is based on laboratory tests which do not replace practical tests. In case of changes in the parameters of the application, such as changes in substrates etc., or in case of a different application, consult Sika's Technical Service prior to using Sika products. The information contained herein does not relieve the user of the products from testing them for the intended application and purpose. All orders are accepted subject to our current terms of sale and delivery. Users must always refer to the most recent issue of the local Product Data Sheet for the product concerned, copies of which will be supplied on request.

900\_NZ020915\_HT24C\_2604\_en\_NZ\_04\_2026

April 2026

**Sika (NZ) Ltd**

85 Patiki Road

Auckland 1026

New Zealand.

Ph. 0800 745 269

www.sika.co.nz

**BUILDING TRUST**



900\_NZ020915\_HT25C\_2604\_en\_NZ\_04\_2026

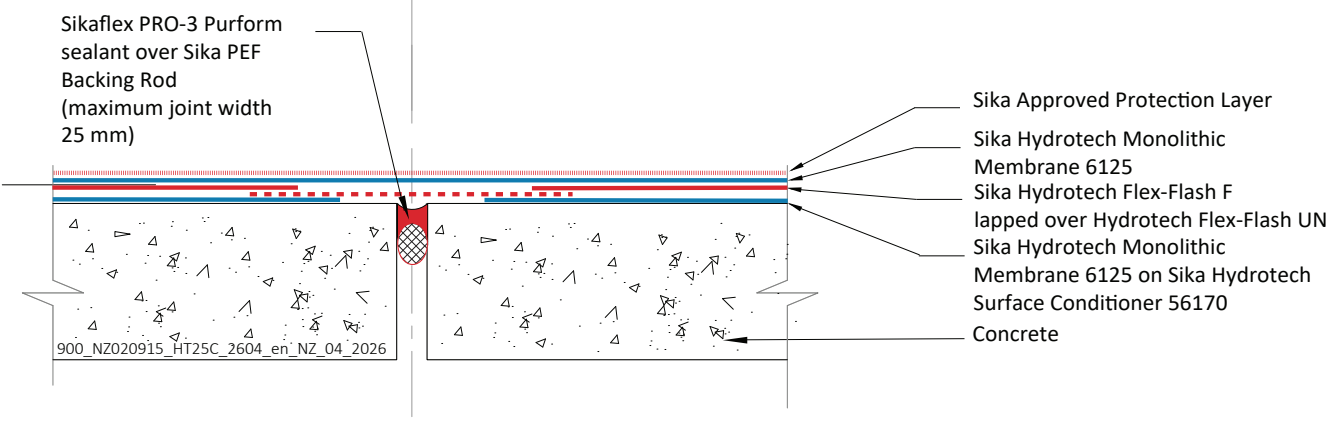
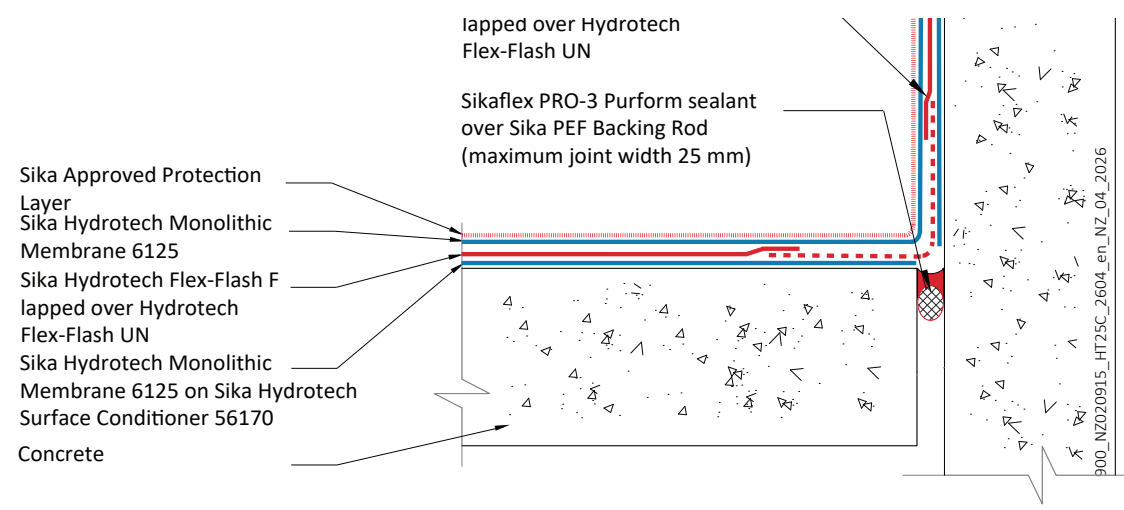

900\_NZ020915\_HT25C\_2604\_en\_NZ\_04\_2026

**SIKA HYDROTECH MONOLITHIC MEMBRANE 6125**  
 Expansion Joints up to 25 mm - Floor and Floor to Wall  
 General Detail. Not to scale.

900\_NZ020915\_HT25C\_2604\_en\_NZ\_04\_2026  
 April 2026

**Sika (NZ) Ltd**  
 85 Patiki Road  
 Auckland 1026  
 New Zealand.  
 Ph. 0800 745 269  
 www.sika.co.nz

DRAWING MUST ALWAYS BE REVIEWED BY A DESIGN SPECIALIST AND IF NECESSARY MODIFIED TO ENSURE SUITABILITY FOR THE SPECIFIC APPLICATION  
 The information contained herein and any other advice are given in good faith based on Sika's current knowledge and experience of the products when properly stored, handled and applied under normal conditions in accordance with Sika's recommendations. The information only applies to the application(s) and product(s) expressly referred to herein and is based on laboratory tests which do not replace practical tests. In case of changes in the parameters of the application, such as changes in substrates etc., or in case of a different application, consult Sika's Technical Service prior to using Sika products. The information contained herein does not relieve the user of the products from testing them for the intended application and purpose. All orders are accepted subject to our current terms of sale and delivery. Users must always refer to the most recent issue of the local Product Data Sheet for the product concerned, copies of which will be supplied on request.





# FOR MORE WATERPROOFING INFORMATION:



## WHO WE ARE

Sika AG, Switzerland, is a globally active specialty chemicals company. Sika supplies the building and construction industry as well as manufacturing industries (automotive, bus, truck, rail, solar and wind power plants, façades). Sika is a leader in processing materials used in sealing, bonding, damping, reinforcing and protecting loadbearing structures. Sika's product lines feature high quality concrete admixtures, specialty mortars, sealants and adhesives, damping and reinforcing materials, structural strengthening systems, industrial flooring as well as roofing and waterproofing systems.

## SIKA (NZ) LTD

Avondale · Auckland  
1746 · New Zealand

## Contact

PO BOX 19192  
Phone 0800 745 269  
www.sika.co.nz

BUILDING TRUST

